

Innovative Xenon Technology with Extremely High Warning Intensity

- Robust, easy-clean domes made of polycarbonate with a handy pressure point locking system
- Integrated inverse polarity protection
- Individually replaceable flash tubes
- **Flexible version:** More flexible, shock-absorbing base cushions against extreme shocks and minimises the danger of damage. The light always returns to the optimum position (maximum tilt: 90°)
- At the same time the flexible housing base serves as a shock absorber
- Theft protection thanks to Allen socket screw fixing
- **SB variants with central bolts:** Variants with separate screw connections available for fixed installation

Technical Data KLX JuniorPlus

Rated voltage (U _N)	12 V	24 V
Operating voltage (U _p)	12–16 V	24–32 V
Interference suppression	Conducted Class 3 (CISPR 25)	
Flash frequency	2 Hz double flash	
Electrical flash energy	10 + 2Ws	
Overall current consumption	3,3 A	1,7 A
Operating temperature range	-40 °C to + 60 °C	
Installation (KLX JuniorPlus F)	From below	
Operating position	Upright	
Protection from inverse polarity	Fuse	
Undervoltage switch-off	4 V	12 V
Protective rating	IP5K4K, IP9K (resistant to dust and highpressure jet cleaners)	

Type Approval

Photometric homologation	Ⓔ 001765, (ECE-R65)
EMC protection	Ⓔ 023486

Product picture and technical drawing

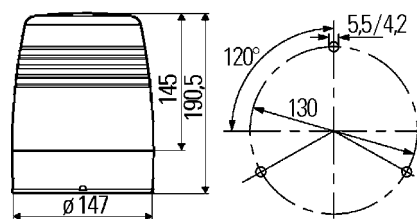

Ideas today for the cars of tomorrow

Product Overview



Part Number	KLX JuniorPlus F				KLX JuniorPlus FL				KLX JuniorPlus M		KLX JuniorPlus SB
	●	●	●	●	●	●	●	●	●	●	●
	2XD 009 051 ...				2XD 009 052 ...				2XD 009 053 ...		2XD 009 054 ...
	-001	-011	-021	-031	-001	-011	-021	-031	-001	-021	-001
Rated voltage 12 V	■		■		■		■		■	■	■
Rated voltage 24 V		■		■		■		■			
Diameter	147	147	147	147	147	147	147	147	147	147	147
Height	145	145	145	145	145	145	145	145	145	145	145
Installation (firmly fixed)	■	■	■	■							
Installation (magnet)									■	■	
Installation (flexible)					■	■	■	■			
Installation from below	■	■	■	■							
Dome material	PC	PC	PC	PC	PC	PC	PC	PC	PC	PC	PC
Dome, amber	■	■			■	■			■		■
Dome, blue			■	■			■	■		■	
Interference suppression Conducted Class 3 (CISPR 25)	■	■	■	■	■	■	■	■	■	■	■

Zubehör und Ersatzteile

Lichthaube (Polycarbonat)	9EL 863 100-031
Innenlinse mit Fresneloptik	9EL 862 678-001
Blitzröhre	8GS 863 261-001

Light distribution

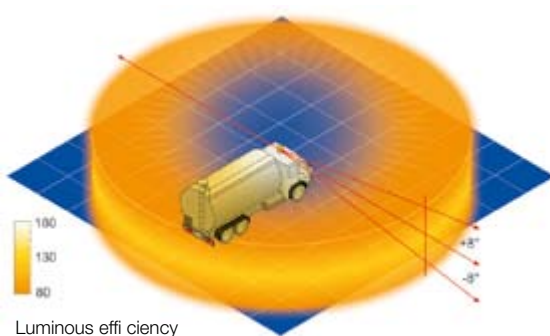

Luminous efficiency in candela (cd)

9EL 863 100-031 Dome, amber
9EL 863 100-051 Dome, blue

