



Opel Antara - engine does not start

Data sheet	
Manufacturer	Opel/Vauxhall
Vehicle model	Antara
Engine	2.2 CDTI
Engine code	A22DMH
Year of manufacture	2011 to 2013
Symptoms	The engine will not start
HELLA parts to replace	8EA 011 612-121
Recommended HGS tool	megamacsX

Important safety information

Engine does not start, faulty electrical connections on the starter

With the above-mentioned vehicle type, it can happen that the starter does not function correctly or it may even fail completely. If the above-mentioned fault arises and no definite faults were found in the periphery of the affected systems during troubleshooting, special attention should be paid to the electrical connections on the starter. Thermal overloads on the electrical connections may be the cause of the malfunction.

In the course of further troubleshooting, the electrical connections on the starter should be visually inspected for thermal overloads. If there are no obvious visual defects, a voltage loss test should be carried out on the battery positive cable from the battery to the starter using a suitable measuring device. The voltage drop in this cable should be a maximum of 0.5 volts.

If there are visible thermal overloads on the battery cable (1) or on the battery positive connection terminal (2) of the starter, or if a defect has been clearly detected on the battery positive cable after measurement assessment, the affected components must be replaced without delay.

The problem has been identified by the vehicle manufacturer and rectified during the course of a service campaign using modified components. For more details on this, contact the vehicle manufacturer or a workshop authorised by the said manufacturer.

Once the cause of the fault has been rectified, delete the error memory and then carry out a test drive.

Please note

Please always follow the repair instructions from the vehicle manufacturer when carrying out such work!

1

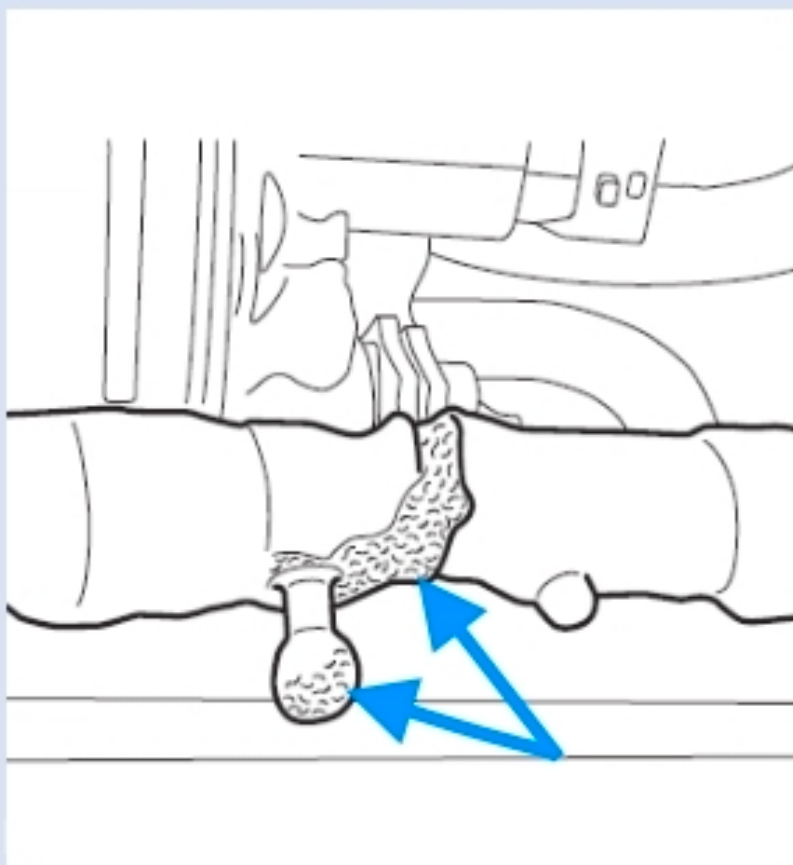

2

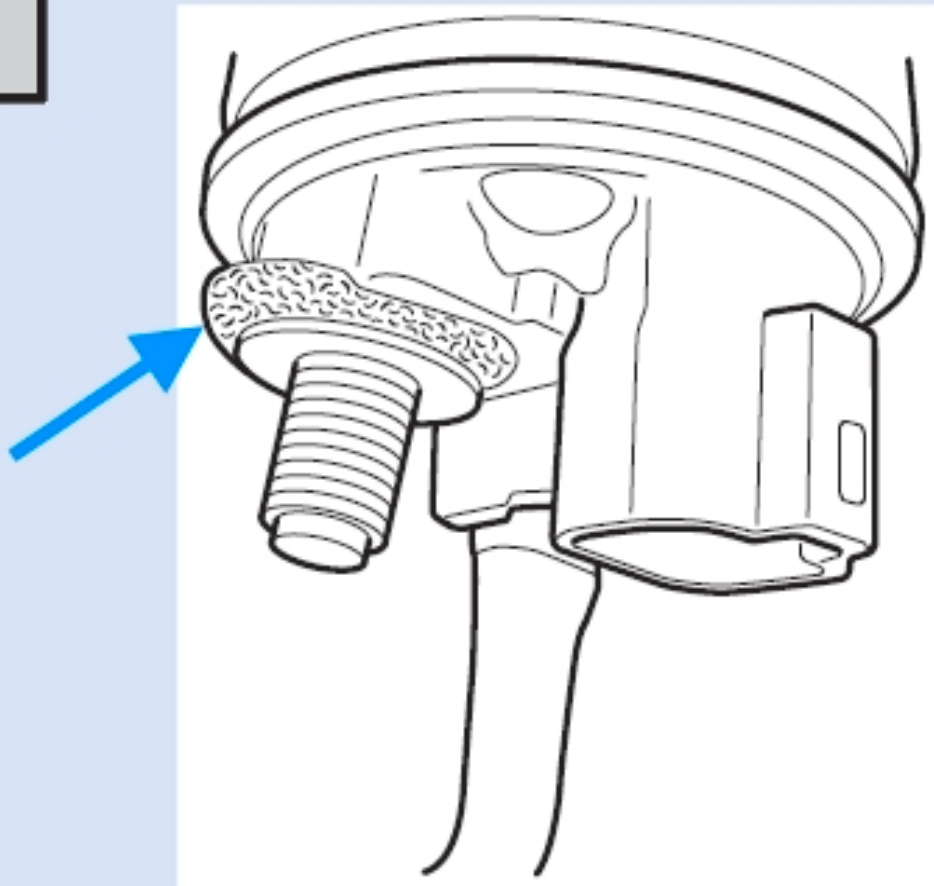

Reprinting, distribution, reproduction, exploitation in any form whatsoever or disclosure of the contents of this document, even in part, is prohibited unless our express permission has been obtained in writing beforehand and the source is stated. The schematic illustrations, pictures and descriptions are provided for explanatory purposes and are only intended as a visual supplement to the document text, so they cannot be used as the basis for installation or assembly work. All rights reserved.