



BRIEF INFORMATION

Front direction indicator lamp 55 mm Gen. 2

- › Uses up to 75 % less power compared to halogen series
- › Slot design integration to avoid condensation
- › Improved homogeneity of light
- › 1:1 fixing to existing front direction indicator series (011 172 LED & 008 221 halogen)

PRODUCT FEATURES

The compact 55 mm front LED direction indicator is designed for both 12 V and 24 V applications, making it an ideal solution across a wide range of vehicle types. Equipped with two LEDs and a grained clear lens, this lamp delivers a striking signal lighting, ensuring increased road safety. The use of advanced LED technology ensures significantly lower power consumption compared to traditional halogen variants – a clear advantage in terms of energy efficiency and sustainability.

Its robust construction makes the lamp waterproof, dustproof and resistant to high-pressure jet cleaning, ensuring reliable performance even under demanding conditions. The lamp's compact design and reduced height make this front direction indicator particularly suitable for vehicles with limited installation space. It can be integrated seamlessly and replaces existing halogen or LED variants in a straightforward 1:1 retrofit.



APPLICATION EXAMPLE

TECHNICAL DETAILS

Technical data

Operating voltage range	Single voltage (9–16 V and 18–32 V)
Rated voltage	12 V and 24 V
Current consumption	12 V: 350 mA 24 V: 200 mA LED failure current: < 50 mA
Power consumption	12 V: 3 W/1.5 W (flashing) 24 V: 4 W/2 W (flashing)
Light function	Front direction indicator
Light source	LED
Material	Housing: PC + ABS Outer lens: PC Inner lens: PC
Weight	Approx. 80 g
Temperature range	-40 °C to +60 °C
Protection class	IP 6K9K, IP 6K7
Approved	ECE-R148, ECE-R10, AIS
Compliant	CISPR 25 Class 3
Protection	12 V and 24 V: Polarity reversal protection, LED short circuit protection 24 V: Overvoltage protection
Mounting	Stud screws
Manufactured in	India

Dimensional sketch

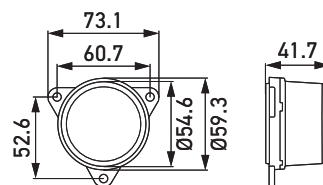

FUNCTIONS



Front direction indicator light

PROGRAM OVERVIEW

Product picture	Rated voltage	Connection	Part number
	12 V	MSSL 150 mm	2BA 328 850-001
	24 V		2BA 328 850-011
	12 V	TYCO 150 mm	2BA 328 850-021
	24 V		2BA 328 850-031
	12 V	Open end wire 520 mm	2BA 328 850-041
	24 V		2BA 328 850-051