



## BRIEF INFORMATION

### HELLA VALUEFIT hand lamps

- Rechargeable hand lamps with micro USB cable
- Compact design for universal applications
- Choose from different light intensities
- Multifunctional use and magnetic attachment

## PRODUCT FEATURES

The new HELLA VALUEFIT hand lamp range offers five handy and rechargeable lamps for workshop, leisure and DIY applications. In addition, a bonnet lamp with a powerful 1,000 lumen light output is available, which can be used in bonnets with a width of 120 to 200 cm using telescopic mounting. These multifunctional lamps can be used quickly and flexibly wherever additional light is required for repair or inspection work.

It is particularly practical that different illumination levels can be selected depending on the intended use. Specially matched to the shape of the lamp, the holders and magnetic attachments offer the right product for every application – especially when you need your hands free to work.

All hand lamps can be recharged using the USB cable included.

# TECHNICAL DETAILS

## USP300

### USB Slim Pocket Light

Slim hand lamp with a 270° foldable lamp body. The metal hook or the strong magnet on the underside of the lamp can be used for fastening.



150-300  
LUMEN



200 g

#### Technical details

|                                  |  |
|----------------------------------|--|
| Floodlight (main light)          | 3 W COB-LED  |
| Torch function (spotlight)       | 1 W LED  |
| Light mode/light output          | Main light (COB LED):<br>150 lm (level 1), 300 lm (level 2)                        |
| Charging time in hours           | Max. 4 h   |
| Operating time in hours          | 4 h (main light, level 1),<br>2.5 h (main light, level 2),<br>6 h (torch function) |
| Battery included                 | 3.7 V/2,000 mAh Li-Ion   |
| Temperature range                | - 10 °C to + 40 °C   |
| Material                         | Aluminium alloy + ABS  |
| Product dimensions               | 185 x 50 x 40 mm   |
| Net weight                       | 200 g  |
| Power supply via micro USB cable | Micro USB, 600 mm long, 5 V 1 A  |
| Magnet                           | Yes  |
| Additional mounting              | Hook   |
| Protection from                  | Short circuit/overcurrent protection,<br>Overcharge/discharge protection           |
| Part number                      | 2XM 357 300-001  |

#### Scope of delivery

- Hand lamp with integrated rechargeable battery
- Micro USB charging port/cable
- Operating instructions



#### Dimensional sketch

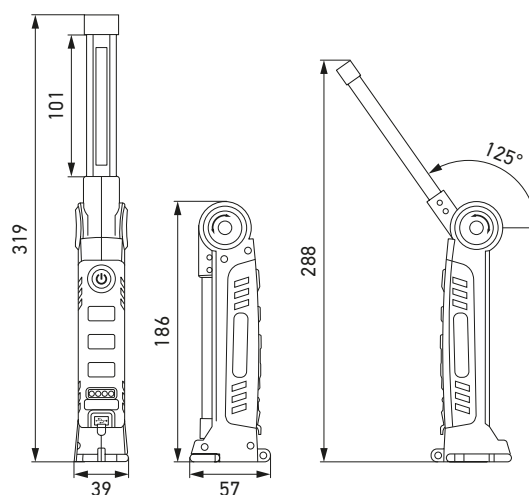

#### Product benefits



1. Practical micro USB charging socket (with protective rubber cap) for easy connection and charging of the battery. | 2. Strong, built-in magnet on the underside for attachment to suitable surfaces. | 3. Metal hook for easy mounting. | 4. Integrated spotlight function. | 5. Eyelet ring for attaching a wrist strap. | 6. Practical charging status display.

# TECHNICAL DETAILS

## UPL150

### USB Pen Light

Light and compact hand lamp in the shape of a pen.

The pocket clip can be rotated 180° and is also equipped with a magnet.



#### Technical details

|                                     |  |
|-------------------------------------|--|
| Floodlight (main light)             | 2 W  |
| Torch function (spotlight)          | 1 W LED  |
| Light mode/light output             | Main light (COB LED):<br>150 lm  |
| Charging time in hours              | 1,5 h  |
| Operating time in hours             | 3 h (main light),<br>4 h (torch function)                                |
| Battery included                    | 3.7 V/800 mAh Li-Ion   |
| Temperature range                   | - 10 °C to + 40 °C   |
| Material                            | ABS  |
| Product dimensions                  | 168 x 23 x 30 mm   |
| Net weight                          | 60 g   |
| Power supply via<br>micro USB cable | Micro USB, 600 mm long, 5 V 1 A  |
| Magnet                              | Yes  |
| Additional mounting                 | Rotating clip  |
| Protection from                     | Short circuit/overcurrent protection,<br>Overcharge/discharge protection |
| Part number                         | 2XM 357 300-101  |

#### Scope of delivery

- Hand lamp with integrated rechargeable battery
- Micro USB charging port/cable
- Operating instructions



#### Dimensional sketch

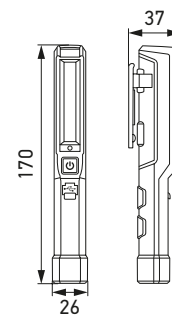

#### Product benefits



1. Pocket clip swivels 180°. | 2. Practical micro USB charging socket (with protective rubber cap) for easy connection and charging of the battery. | 3. Integrated spotlight function.

# TECHNICAL DETAILS

## USL300

### USB stick lamp

Very slim rod lamp for illuminating very narrow areas. The lamp is equipped with a base that swivels 180°. Plus, hook and magnet for flexible handling.



| Technical details                |  |
|----------------------------------|--|
| Floodlight (main light)          | 3 W COB-LED  |
| Torch function (spotlight)       | 2 x 0.2 W LED  |
| Light mode/light output          | Main light (COB LED):<br>150 lm (level 1), 300 lm (level 2)<br>Lamp function:<br>20 lm |
| Charging time in hours           | Max. 4 h   |
| Operating time in hours          | 5 h (main light, level 1),<br>3 h (main light level 2),<br>7 h torch function          |
| Battery included                 | 3.7 V / 2,000 mAh Li-Ion   |
| Temperature range                | - 10 °C to + 40 °C   |
| Material                         | ABS  |
| Product dimensions               | 360 x 40 x 34 mm   |
| Net weight                       | 152 g  |
| Power supply via micro USB cable | Micro USB, 600 mm long, 5 V 1 A  |
| Magnet                           | Yes  |
| Additional mounting              | Hook   |
| Protection from                  | Short circuit/overcurrent protection,<br>Overcharge/discharge protection               |
| Part number                      | 2XM 357 300-201  |

### Scope of delivery

- Hand lamp with integrated rechargeable battery
- Micro USB charging port/cable
- Operating instructions



### Dimensional sketch

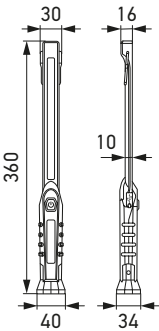

### Product benefits



1. Practical micro USB charging socket (with protective rubber cap) for easy connection and charging of the battery. | 2. Strong, built-in magnet on the underside of the swivelling base for flexible handling. | 3. Ergonomic and non-slip handle so that it can be held safely and comfortably. | 4. Integrated spotlight function. | 5. Practical hook for easy mounting.

# TECHNICAL DETAILS

## UBL1000

### USB bonnet lamp

The bonnet lamp with 1,000 lumen light output for safe work in the engine compartment. With 360° rotating hooks and magnets. The two struts with two magnets each can be folded 90°. The lamp can be used on bonnets with a width of 120 to 200 cm using the extendable struts.



| Technical details                |  |
|----------------------------------|--|
| Floodlight (main light)          | 40 SMD LED   |
| Light mode/light output          | Main light (SMD LED):<br>500 lm (level 1), 1,000 lm (level 2)            |
| Charging time in hours           | Max. 4 h   |
| Operating time in hours          | 8 h (main light, level 1),<br>4 h (main light, level 2)                  |
| Battery included                 | 3.7 V/4,000 mAh Li-Ion   |
| Temperature range                | - 10 °C to + 40 °C   |
| Material                         | Aluminium alloy + ABS  |
| Product dimensions               | 1,200 x 60 x 65 mm   |
| Net weight                       | 900 g  |
| Power supply via micro USB cable | Micro USB, 600 mm long, 5 V 2 A  |
| Magnet                           | Yes  |
| Additional mounting              | Extendable mounting with hooks and magnets (120 – 200 cm)                |
| Protection from                  | Short circuit/overcurrent protection,<br>Overcharge/discharge protection |
| Part number                      | 2XM 357 300-501  |



### Dimensional sketch

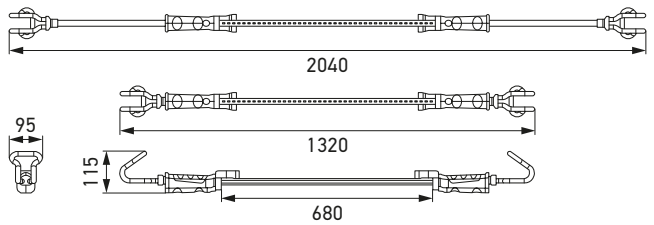

### Product benefits



1. Strong, built-in magnets and 360° rotating hook. | 2. Practical micro USB charging socket for easy connection and charging of the battery. | 3. Extendable struts (120 to 200 cm).

### Scope of delivery

- Bonnet lamp with integrated rechargeable battery
- Micro USB charging port/cable
- Operating instructions

# TECHNICAL DETAILS

## UHL280 AND UHL280 BASE

### Rechargeable USB hand lamp

The practical holder can be rotated by 180°. There are hooks and magnets on the back and two additional magnets on the underside.

The UHL280 BASE variant is a USB rechargeable hand lamp with charging station.



#### Technical details

| Variant                          | UHL280 <sup>1)</sup>   | UHL280 BASE <sup>2)</sup>                  |
|----------------------------------|--|--|
| Floodlight (main light)          | 3 W COB-LED  |  |
| Torch function (spotlight)       | 1 W LED  |  |
| Light mode/light output          | Main light (COB LED):<br>150 lm (level 1), 280 lm (level 2)                        |  |
| Charging time in hours           | Max. 4 h   |  |
| Operating time in hours          | 3 h (main light, level 1),<br>2.5 h (main light, level 2),<br>7 h (torch function) |  |
| Battery included                 | 3.7 V/2,000 mAh Li-Ion   |  |
| Temperature range                | - 10 °C to + 40 °C   |  |
| Material                         | ABS  |  |
| Product dimensions               | 218 x 60 x 35 mm   | 275 x 85 x 75 mm<br>(including base plate) |
| Net weight                       | 300 g  | 330 g                                      |
| Power supply via micro USB cable | Micro USB, 600 mm long, 5 V 1 A  |  |
| Magnet                           | Yes  |  |
| Additional mounting              | Hook   |  |
| Protection from                  | Short circuit/overcurrent protection,<br>Overcharge/discharge protection           |  |
| Part number                      | 2XM 357 300-301  | 2XM 357 300-311                            |

#### Scope of delivery

#### UHL280

- Hand lamp with integrated rechargeable battery
- USB charging port/cable
- Operating instructions

#### UHL280 BASE

- Additional charging station



#### Dimensional sketch

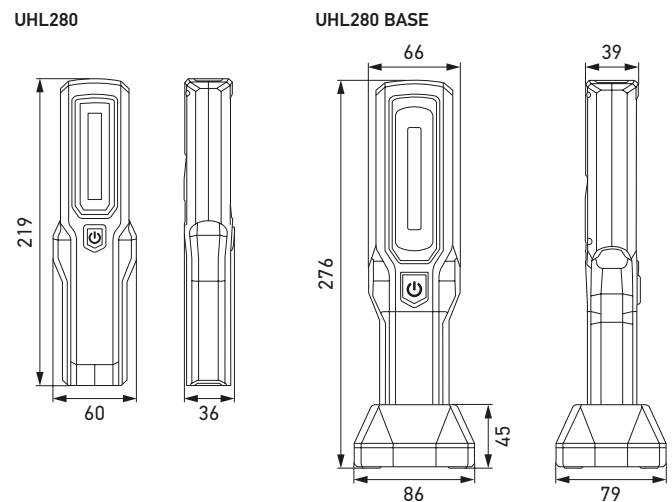

#### Product benefits



1. The bracket can be swivelled through 180°. | 2. Strong, built-in magnets on the underside for attachment to suitable surfaces. | 3. Practical hook for easy mounting. | 4. Practical micro USB charging socket for easy connection and charging of the battery. | 5. Integrated spotlight function.

# APPLICATION EXAMPLES

USP300



UPL150



USL300



UBL1000



UHL280 and UHL280 BASE

