



PRODUCT INFORMATION

Turbo fans

- Airflow can be adjusted using a 2-position switch
- Can be swivelled to all sides and fixed in any position
- Propeller shielded by a guard
- 150 mm propeller
- Lateral, upright or pendant mounting possible

PRODUCT FEATURES

Application

The task of a fan is to move air around in a room. Fans are being used more and more frequently and make everyday life or work more bearable, even on the particularly hot days of the year.

The moving air automatically creates a cooling sensation for human beings.

Design and function

The fan operates by pressing air from back to front, which in turn leads to air circulation.



In this way, air can be optimally distributed throughout the room, which means that fans are used especially on warm summer days.

TECHNICAL DETAILS

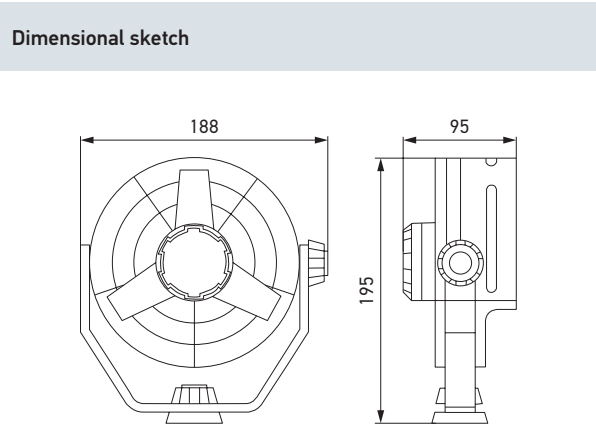
Technical data	
Connecting cable	1,400 mm
Air flow rate	Stage 1: 70 l per second Stage 2: 95 l per second
Power consumption	6.5 W



PRODUCT OVERVIEW

Product image	Description	Part number	VPE*
	Fan, 12 V, black	003361001	1
	Fan, 12 V, white	003361022	1
	Fan, 24 V, black	003361011	1

* Packaging unit