



PRODUCT INFORMATION

AIR TRUMPET HORNS

- Enhanced Safety & Road Presence: The deeper, more authoritative tones of trumpet horns improve vehicle signalling — especially in heavy traffic, bad weather, or when visibility is limited.
- Trusted Brand Heritage: As an established OEM supplier to major automakers, HELLA's signalling devices meet international standards.
- Extremely Loud & Penetrating Sound: Compressed-air technology produces very high acoustic intensity
- Robust Construction for Tough Conditions: HELLA air horns typically feature sturdy housings, often die-cast metal with ABS or chrome-plated trumpets that are resistant to vibration, corrosion, and weather — essential for heavy vehicles and long-term use.

PRODUCT FEATURES

HELLA compressed air trumpets produce a penetrating and long range sound. Ideal for carriers that need to be heard in traffic.

HELLA trumpets are finished in durable materials, their sound is penetrating, and their design is striking, resistant to inclement weather.

Many HELLA air trumpet horns are built to integrate with a vehicle's compressed-air brake system (especially in commercial trucks or buses) including valves and mounting points suited for air lines. This makes them suitable for heavy-duty applications.

Because they use air pressure, these horns can provide a sharp, full-strength note instantly when activated, which is valuable in busy traffic or noisy work environments where an electric horn might struggle to be heard.

Why Compressed Air vs Standard Electric Horns?

Compared with traditional electric horns, compressed air trumpet horns differ in two major ways:

Sound Production: They use air pressure rather than an electro-magnet vibrating a diaphragm, resulting in a fuller, louder, more resonant tone suitable for large vehicles and open spaces.

Application: Ideal for vehicles already equipped with a compressed-air system — especially trucks, buses, trailers, and off-road rigs — but also available with onboard compressors for those without existing air systems.

AIR TRUMPET HORNS

Product image / Dimensions	Features
----------------------------	----------

CA30 SERIES

CHROME SINGLE TONE AIR HORN | SUPER LOUD

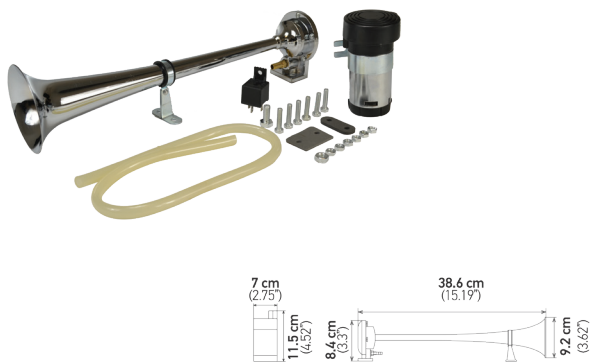

370 Hz

≥ 120 dB (A)

312 W

12/24 V

IP 54

ECE R28

50,000x

Pneumatic operation
Level of acoustic intensity at 2 m distance: 115 dB(A).
Energy consumption: 312 W.
Robust housing. With flat connections of 6.3 mm, open, blade type.
2 holes for M10 fixing screws.
Includes compressor, pressure tubes, fastening and Relay 12 V
Pressure Range: 0.98 bar

Part Number	Quantity	Description
013410001	1 Set	Air Horn using compressed air - Single tone 12 V, 312 W - Universal
013410021	1 Set	Air Horn using compressed air - Single tone 24 V, 312 W - Universal

CA30 SERIES

CHROME DUAL TONE AIR HORN | SUPER LOUD

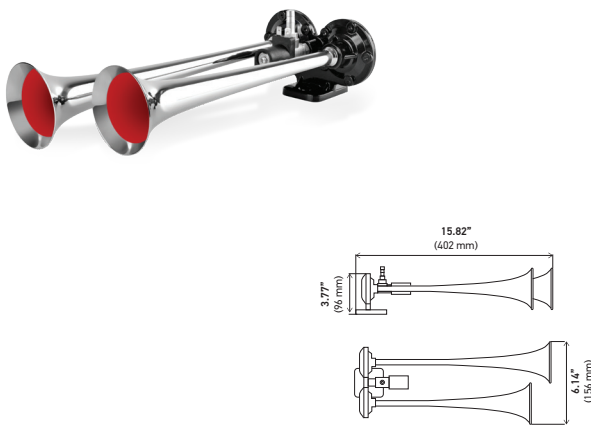

~ 125 dB (A)

41 W / 77 W

12/24 V

For vehicles with compressed air braking system.
Level of acoustic intensity at 2 m distance: 125 dB(A).
Robust housing.
With flat connections of 6.3 mm, open, blade type
Pressure Range: 6 - 8 bar (87 - 116 PSI)

Part Number	Quantity	Description
013410051	1 Piece.	Dual tone compressed air horn - Box 12 V, 41 W - Universal Measurements: 40.2 x 9.6 x 15.6 cm
013410061	1 Piece.	Dual tone compressed air horn - Box 24 V, 77 W - Universal Measurements: 40.2 x 9.6 x 15.6 cm
715991031	1 Set	Replacement solenoid for air trumpet - 12 V
715991041	1 Set	Replacement solenoid for air trumpet - 24 V

CA20 SERIES

SINGLE TONE AIR HORN | SUPER LOUD



400 Hz

~ 118 dB (A)

120 W

12-24 V

IP 54

ECE R28

50,000x

For vehicles with a compressed air brake system.
Pneumatic operation
Level of acoustic intensity at 2 m distance: 115 dB(A).
Energy consumption: 120 W.
Robust Housing
Suitable for tubular fittings Ø 8 mm. 2 holes for M10 fixing screws.
Pressure Range: 5.88 bar

Part Number	Quantity	Description
013410011	1 Piece	Compressed air horn - Single tone 12 - 24 V, 120 W - Universal Measurements: 11.6 x 14.4 x 20.3 cm

AIR TRUMPET HORNS

Product image / Dimensions	Features
----------------------------	----------

CA26 SERIES

ELECTROPNEUMATIC HORN | COMPACT

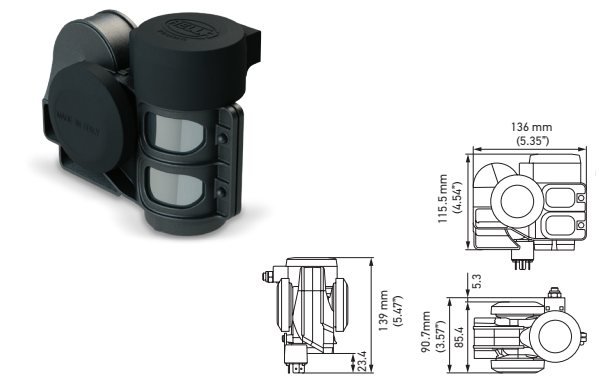

Super compact design with horn and air compressor in one module.
The integrated compressor enables immediate sound output.
Necessary mounting kits and relay are included. ABS housing.
Level of acoustic intensity at 2 m distance: 112 dB(A).
Energy consumption: 120 W.
Mounting bracket included. Approval: ECE
Operating Temperature: -40° C a 75° C (-40°F a 167°F)

Part Number	Quantity	Description
013410081	1 Piece	1 Electropneumatic horn 12 V, 120 W, 520 / 660 Hz - Universal
013410091	1 Piece	1 Electropneumatic horn 24 V, 120 W, 520 / 660 Hz - Universal

CA10 SERIES

RED TWIN TONE AIR HORN | LOUD

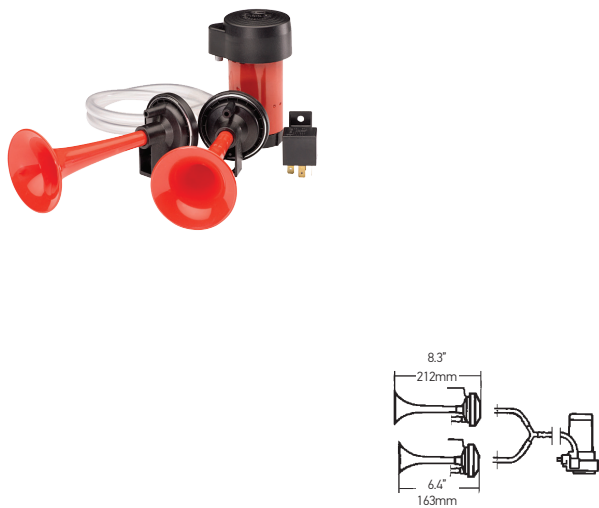

Compressed air horn with ABS plastic body and support in galvanized metal
Level of acoustic intensity at 2 m distance: 118 dB(A).
Energy consumption: 240 W.
Mounting bracket included
Operating Temperature: -40° C a 90° C (-40°F a 194°F)
Approval: ECE

Part Number	Quantity	Description
003001651	1 Set	2 Electric Horns - Pneumatic 12 V, 240 W, 780 / 840 Hz - Universal Length of Trumpets: 16.3 cm 21.2 cm Includes compressor, pressure tubes, bifurcated Piece Fastening and Relay 12 V
003001661	1 Set	2 Electric Trumpets - Pneumatic 24 V, 240 W, 780 / 840 Hz - Universal Length of Trumpets: 16.3 mm 21.2 cm Includes compressor, pressure tubes, bifurcated Piece Fastening and Relay 24 V

CA12 SERIES

RED TRIPLE TONE AIR HORN | LOUD

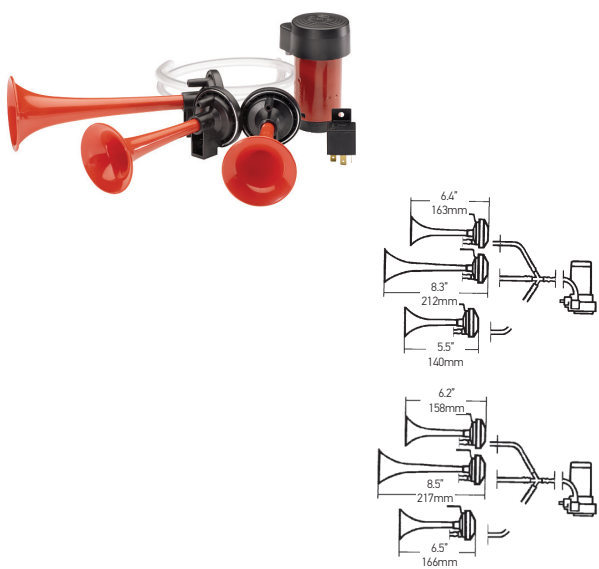

Compressed air horns with ABS plastic body and support in galvanized metal
Level of acoustic intensity at 2 m distance: 118 dB(A).
Energy consumption: 240 W.
Mounting bracket included
Operating Temperature: -40° C a 90° C (-40°F a 194°F)
Approval: ECE

Part Number	Quantity	Description
003001671	1 Set	3 Electric Horns - Pneumatic 12 V, 240 W, 780 / 820 / 880 Hz - Universal Length of Trumpets: 14 cm 16.3 cm 21.2 cm Includes compressor, pressure tubes, bifurcated Piece Fastening and Relay 12 V
003001981	1 Set	3 Electric Trumpets - Pneumatic Melodic Sound 12 V, 240 W, 630 / 795 / 840 Hz - Universal Length of Trumpets: 15.8 cm 16.6 cm 21.7 cm Includes compressor, pressure tubes, bifurcated Piece Fastening and Relay 12 V

AIR TRUMPET HORNS

Product image / Dimensions	Features
----------------------------	----------

CA34 SERIES

CHROME TWIN TONE AIR HORN | HIGH WAY

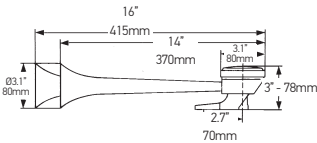

For vehicles with a compressed air brake system.
Chromed lid and trumpet, matt black base
Pneumatic operation
Level of acoustic intensity at 2 m distance: 118 dB(A).
Energy consumption: 0 - 20 W.
Suitable for tubular fittings Ø 8 mm.
2 holes for fixing screws M10.
Approval: ECE
Pressure Range: 4 - 8.3 bar

Part Number	Quantity	Description
005411001	1 Piece	Compressed air horn 24 V, 0 - 20 W, 300 - 350 Hz - Universal Measurements: 7.8 x 16 x 41.5 cm



Accessories

The horn can be operated in three different ways:

Part Number	Quantity	Description
1 715989001	1 Set	Mounting on the roof of the cab. Drive pulling the pull cable coated, 120 cm long. Traction Valve.
2 715991001	1 Set	Mounting in the engine compartment. Drive by pressing Horn button. With flat connections of 6.3 mm, open. Power absorbed: 20W. Electric valve, 24V.

Product features, specifications and availability are subject to change without notice.

HELLA Automotive Sales, Inc.
611 Highway 74 S, Suite 102
Peachtree City, GA, 30269
Tel.: +1 (877) 224-3552
Fax: +1 (770) 631-7574
www.hella.com/us/
www.myhellalights.com