



BRIEF INFORMATION

LED multi-function light 980 720 - ...

- LED lights for 12 V and 24 V
- For horizontal and vertical mounting
- Long design life with low power consumption

PRODUCT FEATURES

LED lighting technology

Homogenous illumination and an excellent signalling effect is achieved at a very low level of power consumption by combining efficient light-emitting diodes (LEDs) and precision optics. LED lights from HELLA are fully sealed and maintenance-free!

Resistant to UV radiation

Especially resistant to tough environmental influences without materials becoming brittle or fading!

Hermetically sealed

Tested in accordance with HELLA Norm 67101 and IP 6K9K/IP 6K7. The lights are resistant to high-pressure jet cleaning and sporadic immersion.

Polarity reversal protection

The light does not suffer any damage if the poles are connected incorrectly.

Installation

The light is equipped with an open-ended 500 mm cable for straightforward installation.

Fixing

The light is fastened from the front and rear by means of a detachable retaining frame. There are 6 holes available for screw attachment.

TECHNICAL DETAILS

| Technical specifications | |
|------------------------------|--|
| Operating voltage | 12 V and 24 V |
| Functions | Tail light: 2 red LEDs Stop light: 4 red LEDs Indicator: 4 yellow LEDs |
| Current consumption | Tail light: 1 W Stop light: 2 W Indicator: 2 W |
| Fixing | 4 holes Ø 4.2 mm each and 2 holes Ø 5 mm each |
| Mounting | Not approved for double attachment |
| Operating temperature | -40°C to +60°C |
| Type approval | ECE, ADR (for Australia and New Zealand) |
| Specification | HELLA Norm 67101, class 2.2 and 7.2 |
| EMC approval | Yes |
| Polarity reversal protection | Yes |
| IP protection class | IP 6K9K / IP 6K7 |

Technical drawing

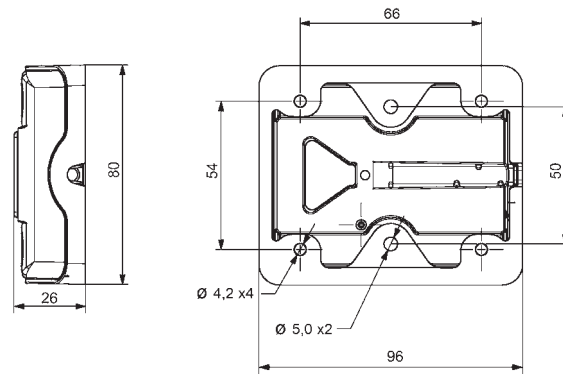

| Cable colour | Function |
|--------------|------------|
| White | Earth (-) |
| Red | Stop light |
| Blue | Indicator |
| Brown | Tail light |

RANGE OVERVIEW

| Product image | Part number | Specification | Voltage | Type approval | PU |
|---|------------------------|--|--|---------------|--------|
|  | 2VA 980 720-001 / -007 | SBBLR tail light/stop light/indicator with reflex reflector for horizontal and vertical mounting (light can be turned through 180°), clear-glass lens, 8 LEDs, reflex reflector (firmly glued in place 8RA 004 412-021), 500 mm cable with stripped ends, detachable black retaining frame with 6 holes for individual attachment. | 12 / 24 V | ECE | 1 / 20 |
| | 2VA 980 720-011 / -017 | As 2VA 980 720-001 / -007, but with 150 mm cable and DT connector. | 12 / 24 V | ECE | 1 / 15 |
| | 2VB 980 720-401 / -407 | Indicator at top, licence plate light on left | 12 / 24 V | ECE | 1 / 20 |
| | 2VB 980 720-501 / -507 | Indicator at bottom, licence plate light on left | SBBLR tail light/stop light/indicator with reflex reflector for horizontal mounting, can be attached turned 180°, with licence plate lighting for plates measuring 370 mm x 120 mm and 520 mm x 120 mm. For illumination of a licence plate from the left and right, use 2VB 980 720-401 and -501 lights respectively. | 12 / 24 V | ECE |

* The individual light functions may only be operated with a vehicle fuse of max. 3 A. The indicator failure monitor in accordance with section 6.5.8 of ECE-R48, which is a legal requirement where ECE-R48 applies, must be ensured by suitable means within the vehicle. The customer is responsible for this. Fitting two units on one side of the vehicle is not permitted.