

High Tech · Tuning · Performance

Light modules from Hella



***Ideas today for
the cars of tomorrow***

Retrofit cornering light from Hella **DynaView® Evo2**

World premiere!

A new lighting era

DynaView® Evo2 combines the safety functions cornering light and fog light in compact round auxiliary lights which can be retrofitted to any passenger car/estate car or off-road vehicle.



With the low beam switched on, **the cornering light** is activated on the right or left without delay when the indicator is operated, or automatically when driving round bends at speeds up to 40 km/h / 25 mph.

When driving round bends a yaw rate sensor measures the **turning speed** of the vehicle and triggers the switching pulse. After the bend, a dimmer gently switches the light cone off again.

The **DynaView® Evo2** auxiliary lights are also approved for use as fog lights.

If required, both cornering lights can be activated at once via a separate switch and ensure **additional safety when driving in foggy conditions**. The computer-calculated free-form reflectors have been specially designed for broad illumination of the areas alongside the front-end of the vehicle.

The **metal reflector** of the cornering auxiliary light is weather-sealed and resistant to external influences. With its real glass cover lens the style of the **DynaView® Evo2** blends in perfectly with the front skirts of modern vehicles.

By the way: when the vehicle is put into reverse, both cornering lights switch on and illuminate the areas to the right and left of the vehicle broadly and brightly.



Scope of supply

The complete **DynaView® Evo2 headlight set** comprises:

- 2 x headlights (left and right)
- 2 x high-quality H7 bulbs
- IntelliBeam® control unit with yaw rate sensor
- Pre-assembled professional harness
- Bracket and fastening material
- Detailed installation instructions
- Approval certificate (with information about legislation and approval notes)

DynaView® Evo2 incl. 12 V H7 bulb
with holding bracket

① Set incl. control electronics	1N0 009 295-801
individual light, left	1N0 009 295-011
individual light, right	1N0 009 295-021

Individual headlight incl. 12 V H7 bulb
with carrier frame

② individual light, left	1N0 009 295-031
② individual light, right	1N0 009 295-041

③ IntelliBeam® control electronics	5DF 009 244-007
------------------------------------	-----------------

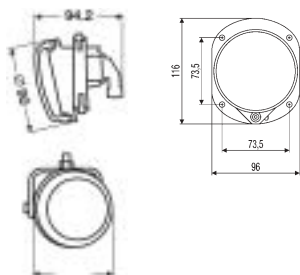

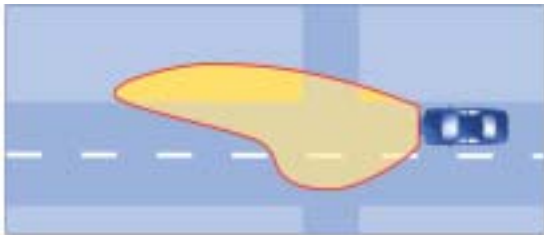

Standard low beam **without** DynaView® Evo2



Further information: www.hella.com/dynaview

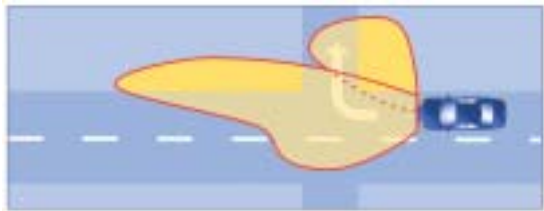

Driving round bends:

At speeds of up to 40 km/h the automatic IntelliBeam® G-sensor switches the cornering light on in addition to the low beam.

Turning off procedure:

At speeds of up to 40 km/h either the left-hand or the right-hand cornering light is switched on by the flasher unit.



Driving in fog:

Additional function: fog light
In foggy conditions both lights can be switched on together as fog lights.



Table of contents



Front

DynaView® Evo2 World premiere!	Page	2-3
Premium headlight modules		
Xenon low beam headlight	Page	5
Halogen low beam headlight	Page	5
Xenon spotlight	Page	5
Halogen spotlight New!	Page	5
Fog light	Page	5
Spare parts and accessories	Page	22
90 mm headlight modules		
Bi-Xenon headlight	Page	7
Xenon low beam headlight	Page	6
Halogen low beam headlight	Page	6
Xenon spotlight New!	Page	7
Halogen spotlight	Page	7
Fog light	Page	6
Spare parts and accessories	Page	22
Xenon accessories		
Lens cleaning system	Page	8
Ultrasonic headlight range adjustment	Page	9
Premium frontlight modules		
Indicator	Page	10
Position light	Page	10
Accessories	Page	23
55/60 mm frontlight modules		
Indicator	Page	10
Position light	Page	10
Accessories	Page	23
Daytime running light	Page	11
Auxiliary lights		
DE Xenon Premium Edition	Page	12
DE Xenon	Page	12
Micro DE Premium Edition	Page	12
Micro DE	Page	12
FF 75	Page	13
FF 75 Blue	Page	13
FF 50	Page	13
FF 50 Blue	Page	13
Spare parts and accessories	Page	22



Page

Auxiliary indicators		
with bulb	Page	14
with LED	Page	15
LED side marker lights	Page	15



Rear

Premium rearlight modules		
Taillight	Page	16
Stoplight	Page	16
Combined tail/stop light	Page	16
Indicator	Page	16
Rear fog light	Page	16
Reverse light	Page	16
Macro-reflector	Page	16
LED Premium circular ring New!	Page	17
Spare parts and accessories	Page	23
55 mm rearlight modules		
Taillight	Page	18
Stoplight	Page	18
Indicator	Page	18
Rear fog light	Page	18
Reverse light	Page	18
Reflector	Page	18
LED circular ring	Page	18
Spare parts and accessories	Page	23
Safety stoplights	Page	19
Know-how		
Legal requirements and installation regulations		
Front	Page	20
Page	Page	21
Rear	Page	20

Premium headlight modules

Compact flush-fit headlight with 50 mm light aperture. High-grade modern metal materials. Sophisticated aluminium housing offers an attractive design. Excellent light output despite minimum dimensions. Low beam and spotlight each available as an innovative xenon version or with modern halogen lighting technology. Also available as a halogen fog light.

Low beam headlights

Installation frame for 3-point fastening. Halogen H7 or D2S Xenon light sources included in the scope of supply. Carrier frame, headlight range adjustment actuator, caps and connectors available as accessories.

Xenon

Right-hand traffic 12 V, D2S	ECE	1BL 009 071- 041
Left-hand traffic 12 V, D2S	ECE	1ML 009 071- 051
Right-hand traffic 24 V, D2S	ECE	1BL 009 071- 061
Left-hand traffic 24 V, D2S	ECE	1ML 009 071- 071
Right-hand traffic 12 V, D2S	SAE	1BL 009 071- 091

Halogen

Right-hand traffic 12 V, H7	ECE	1BL 009 071- 001
Left-hand traffic 12 V, H7	ECE	1ML 009 071- 011
Right-hand traffic 24 V, H7	ECE	1BL 009 071- 021
Left-hand traffic 24 V, H7	ECE	1ML 009 071- 031
Right-hand traffic 12 V, H7	SAE	1BL 009 071- 081

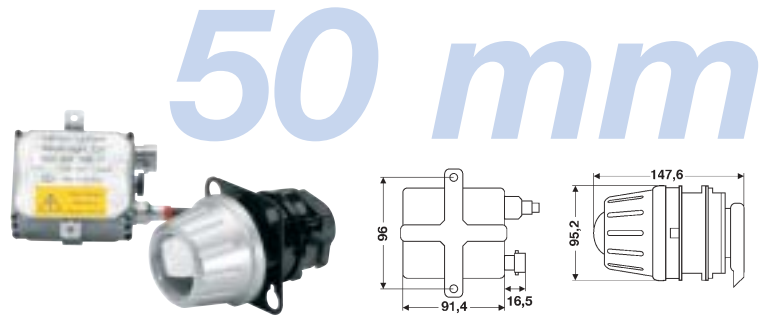

Spotlights

Reference number: 17.5. 3-point attachment, can be adjusted using setting screw, carrier frame available as an accessory.

Xenon

12 V, D2S	ECE/SAE	1F0 008 390-317
24 V, D2S	ECE/SAE	1F0 008 390-327

Halogen

12 V, H9	ECE/SAE	1KL 009 486-001
----------	---------	-----------------

Available from 1st quarter 2006

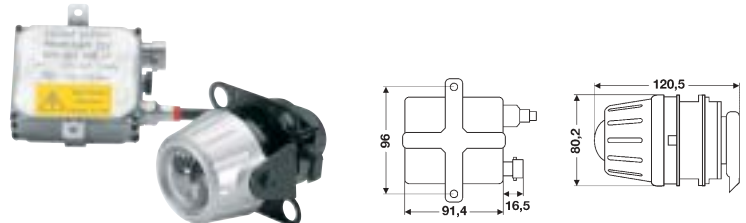

Fog lights

H3 bulb, 3-point attachment, can be adjusted using setting screw, carrier frame available as an accessory.

Halogen

12 V, H7	ECE/SAE	1NL 008 090-317
24 V, H7	ECE/SAE	1NL 008 090-327

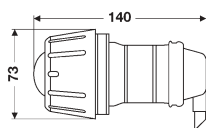

90 mm headlight modules



Headlight module with pattern-free real-glass cover lens. Slim dimensions for a discreet and convincing light design. Available as fog, low beam, high beam and Bi-Xenon light module.

Low beam headlights

Headlight module with pattern-free glass cover lens. Minimum installation dimensions for a discreet and convincing light design. Metal reflectors with clear DE lens. Ideal in combination with the matching spotlights and fog lights. Incl. light sources.

90 mm

Xenon

Right-hand traffic	12 V, D2S	ECE	1BL 008 194-007
Left-hand traffic	12 V, D2S	ECE	1LL 008 194-037
Right-hand traffic	24 V, D2S	ECE	1BL 008 194-027
Left-hand traffic	24 V, D2S	ECE	1LL 008 194-057
Right-hand traffic	12 V, D2S	SAE	1BL 008 194-047
Left-hand traffic	12 V (Japan version)		1LL 008 194-017

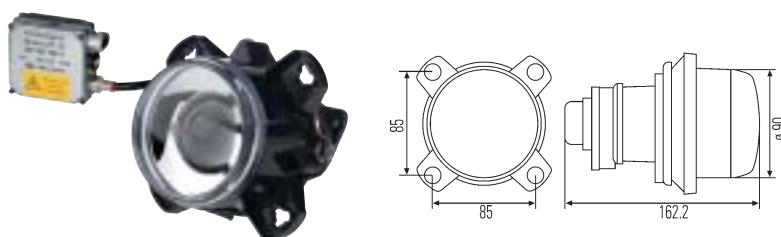

Halogen

Right-hand traffic	12 V, H7	ECE	1BL 008 193-001
Left-hand traffic	12 V, H7	ECE	1LL 008 193-117
Right-hand traffic	24 V, H7	ECE	1BL 008 193-011
Left-hand traffic	24 V, H7	ECE	1LL 008 193-127
Right-hand traffic	12 V, H9	SAE	1BL 008 193-021

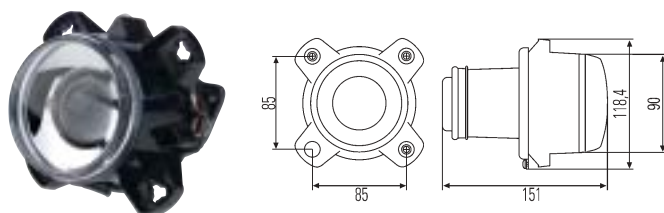

Fog lights

Minimum installation dimensions for a discreet and convincing light design. Metal reflectors with clear lens. Ideal in combination with the matching 90 mm spotlights and low beam headlights. Incl. H7 bulb.

Halogen

12 V, H7	ECE/SAE	1N0 008 582-001
24 V, H7	ECE/SAE	1N0 008 582-011

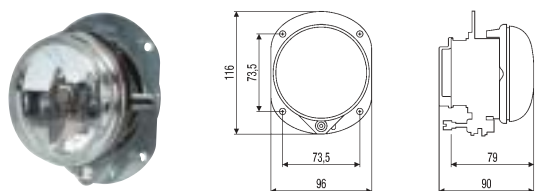

Spotlights

Headlight module with metal FF reflectors and clear lens. Ideal in combination with the 90 mm low beam headlights and fog lights. Xenon and halogen versions. Incl. light sources.

Xenon (Ref. 37.5)

with position light	12 V, D2S	ECE/SAE	1K0 008 192-007
without position light	12 V, D2S	ECE/SAE	1K0 008 192-017
with position light	24 V, D2S	ECE/SAE	1K0 008 192-027

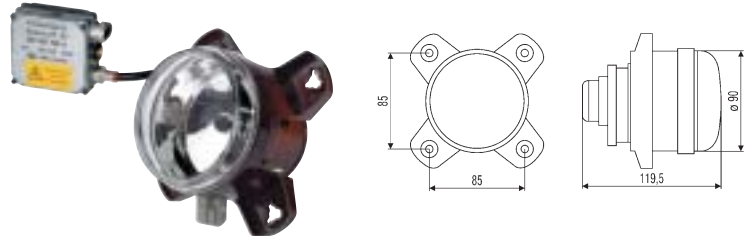

Halogen

with position light	12 V, H7	ECE	1K0 008 191-001*
without position light	12 V, H7	ECE	1K0 008 191-021*
with position light	24 V, H7	ECE	1K0 008 191-021**
without position light	12 V, H9	ECE/SAE	1K0 008 191-051**
with position light	12 V, H9	ECE/SAE	1K0 008 191-131**

* Ref. 12.5

** Ref. 17.5

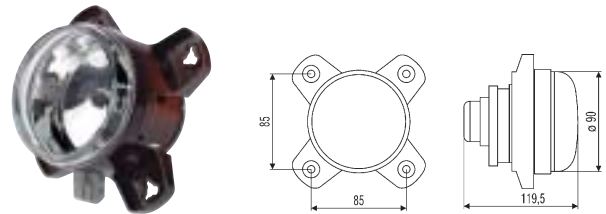

Bi-Xenon

Xenon low beam and high beam light in a single headlight. Headlight module with integrated ignition unit and pattern-free glass cover lens. High-grade metal reflector. Waterproof 4th generation Xenon ballast. 1 metre of shielded supply cable with separable plug-type connectors.

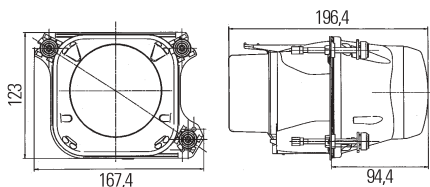

Scope of supply

Bi-Xenon headlight incl. D2S Xenon bulb, Xenon ballast, shielded cable, fastening material

Right-hand traffic	12 V, D2S	ECE	1AL 008 934-001
Left-hand traffic	12 V, D2S	ECE	1LL 008 934-011
Right-hand traffic	24 V, D2S	ECE	1AL 008 934-021*
Left-hand traffic	24 V, D2S	ECE	1LL 008 934-031*
Right-hand traffic	12 V, D2S	SAE	1AL 008 934-041

* When 24 V is used the 12 V voltage reduction device 8ES 006 658-001 must be ordered separately for switching low beam/high beam.

Accessories for Bi-Xenon

20 connectors for ballast	8JA 990 295-127
20 connectors for high beam switchover	8JD 162 211-801



Lens cleaning systems



Legislation prescribes the use of a lens cleaning system whenever Xenon low beam headlights are used. (The use of such a system is also recommended for halogen headlights and high beam.)

Hella cleaning systems work according to the water-jet principle which does without wipers and brushes; dirt particles are blasted from the lens by the kinetic energy of the water drops and then rinsed off.

The water pressure required for the cleaning procedure is produced using a centrifugal pump. High-speed water drops are formed in special Hella vortex chamber nozzles. Appropriately constructed valves in front of the nozzles prevent water escaping from the supply tank and also help save water.

In case static nozzles cannot be used on account of an unfavourable lens position, Hella has alternative solutions to offer: Telescopic nozzle systems which move into the required working position for the duration of the cleaning process.

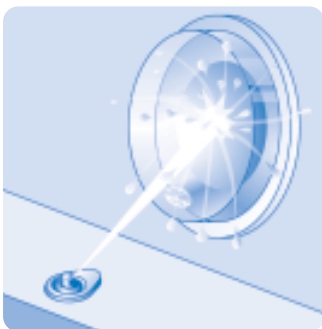

with stationary nozzles

12 V 8WS 008 549-001

24 V 8WS 008 549-501

as 8WS 008 549-001,
but with longer cables

12 V 8WS 008 549-011

These lens cleaning systems are ECE type-approved for the following Hella headlight ranges when installed in accordance with the mounting instructions provided.

Ø 50 mm: 1BL 009 071-...

1ML 009 071-...

1FO 008 390-...



with telescopic single nozzles

12 V 8WT 008 549-101

24 V 8WT 008 549-601

Ø 90 mm: 1KO 008 191-...

1KO 008 192-...

1BL 008 193-...

1BL 008 194-...

1AL 008 934-...

1LL 008 934-...



with telescopic double nozzles

12 V 8WT 008 549-201

24 V 8WT 008 549-701

Complete sets.
Water tanks
are not included in the
scope of supply.

Xenon



Ultrasonic headlight range adjustment

The ultrasonic system is a universal headlight range adjustment system for original equipment and for retrofitting to vehicles with xenon low beam headlights of the Hella model series 008 194-..., 009 071-..., 008 934-... . Type-approved in combination with the above-mentioned headlight model series.

The sensor in this system measures the distance from the underside of the vehicle to the roadway and forwards the signal to the central control unit, which then provides the optimum headlight setting on the xenon headlights via the servomotors.

See the mounting instructions for more detailed information.

Optimum sensor placement
for 1 or 2 sensor mounting

Sensor mounting

Mounting equipment

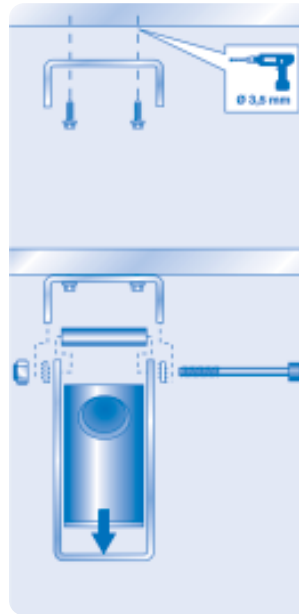
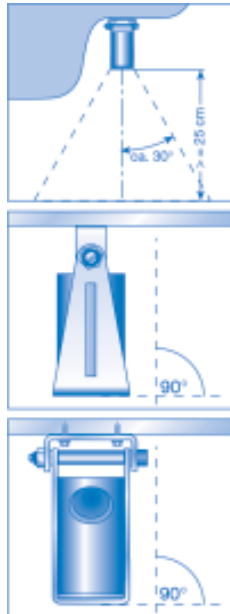
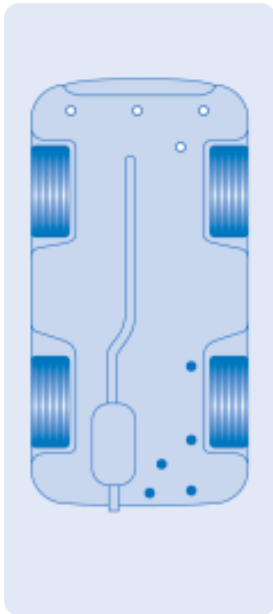

1 sensor (car), 12 V	8XX 008 614-011
2 sensors (3,5 t), 12 V	8XX 008 614-031
2 sensors (CV), 24 V	8XX 008 614-101
Extension set / 2nd sensor incl. cable assembly	8XX 008 644-001



System structure in the vehicle

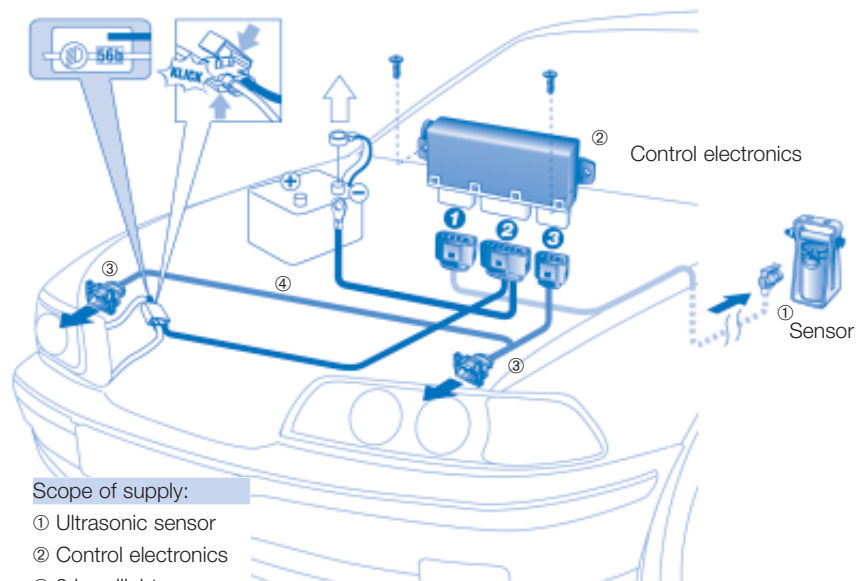

Scope of supply:

- ① Ultrasonic sensor
- ② Control electronics
- ③ 2 headlight range adjustment actuators
- ④ Harness



Premium frontlight modules

Clear glass, pattern-free lens, high-quality facet optics and a homogeneous signal image – these are only some of the most important design features of the new Premium light modules. Compact dimensions and the small installation depth of only 80 mm present new design possibilities. Ideal where there is little design space to spare.

Indicator light

for flush-fitting at the front, clear

① incl. bulb PY21W	ECE	2BA 009 001-071
② incl. silver-coloured bulb	ECE	2BA 009 001-201
① incl. bulb 1156A 24CP	SAE	2BA 009 001-091



Premium

Position light

clear

incl. bulb P21W	ECE/SAE	2PF 009 001-081
-----------------	---------	-----------------

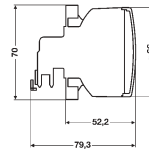

55/60 mm frontlight modules

55 mm indicator

for 12 V and 24 V	ECE	2BA 008 221-001
with pre-fitted amber 12 V/21 W bulb	ECE	2BA 008 221-107
Harness with grommet		8KA 152 134-007

55 mm position light

(not illustrated, version as per indicator)	ECE	2PF 008 221-011
Harness with grommet		8KA 152 134-007

60 mm indicator/position light

with pre-fitted 12 V/21 W bulb 1157NA	SAE	2BA 008 947-007
---------------------------------------	-----	-----------------

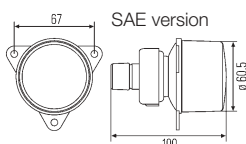
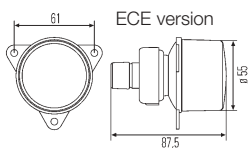

Automatic daytime running light

European studies show:

When vehicles drive with their lights on during the day, the number of potentially fatal collisions is reduced by 25% in comparison to vehicles without lights on. If less serious accidents are included in these figures, it can even be said that more than 50% of all collisions are due to other road users being overlooked.



Without daytime running light



With daytime running light

Daytime running light – the advantages at a glance:

- The daytime running light is activated when the key is turned in the ignition
- Optimum recognizability in road traffic
- Special signal image for daytime driving
- Increased accident protection
- Minimum current requirements



Daytime running light set

2 lights incl. harness,
halogen bulbs and universal bracket for flush-fitting 12 V/6 W
for surface-mounting 12 V/6 W 2PT 008 362-801

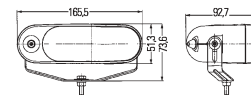

Daytime running lights with a clear-glass design
with high-performance bulbs

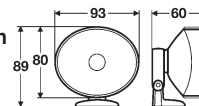

Individual light

for flush-fitting, with bracket 12 V/16 W 2PT 008 935-011

Set – two lights incl. pre-fitted professional harness, incl. light sources, with universal bracket

for surface-mounting 12 V/16 W 2PT 008 935-801

for surface-mounting 24 V/16 W 2PT 008 935-811

www.Tagfahrlicht.de



DE Xenon / Micro DE



Small, compact and extremely powerful – ideal for mounting on front spoilers and skirts

The award-winning model series with a powerful light performance. High-grade materials for a long service life and low weight. Hella's smallest line of auxiliary lights for difficult surface-mounting and flush-fitting applications. Also available as **Premium Edition** modules which give that special something to any vehicle.

Spotlights

DE Xenon

Spotlight (Ref. 17.5), 12 V, black housing colour, incl. D2S Xenon bulb and electronic ballast

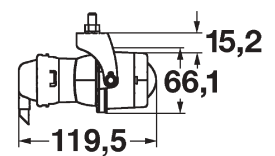

DE Xenon Premium Edition

Set	ECE/SAE	1F0 008 390-821
Individual	ECE/SAE	1F0 008 390-301

DE Xenon

Set	ECE/SAE	1F0 008 390-801
Individual	ECE/SAE	1F0 008 390-001

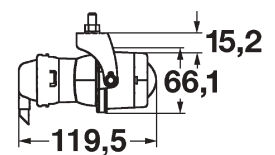
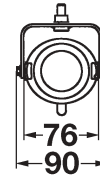

Fog lights

Micro DE

Fog light, black housing colour, incl. H3 bulb

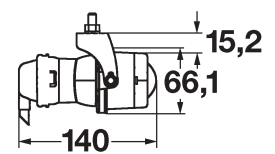
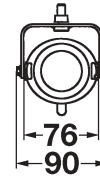

Micro DE Premium Edition

Set with radio remote control system	ECE/SAE	1NL 008 090-871
Individual	ECE/SAE	1NL 008 090-301

Micro DE

Set with radio remote control system	ECE/SAE	1NL 008 090-831
Set	ECE/SAE	1NL 008 090-821
Individual	ECE/SAE	1NL 008 090-031

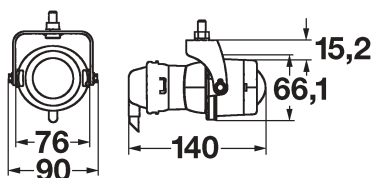

FF 50 / FF 75

Compact on the outside and powerful inside – thanks to high-grade materials and compact design

Top quality and light performance even with these compact models. FF reflector, clear lens and high-quality H7 bulb ensure remarkably homogenous illumination of the road without scatter loss. For upright and pendant installation. Flat and oval designs for integration in modern vehicle front-ends.

FF 50

Halogen auxiliary lights

Sets with 12 V/H7 bulbs relay with cable and accessories, for upright or pendant mounting

High beam set	ECE/SAE	1FA 008 283-811
Fog light set	ECE/SAE	1NA 008 283-801
With blue lens		
Individual spotlight	ECE/SAE	1FA 008 283-031

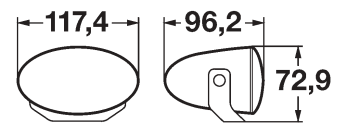

Cool Blue

FF 75

Halogen auxiliary lights

Sets with 12 V/H7 bulbs relay with cable and accessories, for upright or pendant mounting

High beam set	ECE/SAE	1FA 008 284-811
Fog light set	ECE/SAE	1NA 008 284-801
With blue lens		
Individual spotlight	ECE/SAE	1FA 008 284-031

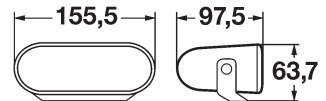

Auxiliary indicators



①



②



③



④



⑤

Bulb versions

Auxiliary indicators, application overview

① 9EL 156 099-801

Volkswagen Golf IV	10/1997 →
Volkswagen Polo III+IV	10/1999 →
Volkswagen Passat B5	10/1996 →
Volkswagen Bora	11/1998 →
Volkswagen Lupo	05/1998 →
Volkswagen Sharan	07/2000 →
Seat Toledo	03/1999 →
Seat Leon	10/1999 →

② 9EL 156 099-811

Audi A3	09/1996 → 08/2000
Audi A4	→ 04/1999
Audi A8	→ 12/1998
Seat Ibiza	09/1999 →
Skoda Octavia	04/1997 →
Skoda Fabia	01/2000 →

③ 9EL 156 099-841

Audi A2	06/2000 →
Audi A3	09/2000 →
Audi A4 saloon	05/1999 → 10/2000
Audi A4 Avant	05/1999 → 09/2001
Audi A6	05/1997 → 06/2001
Audi A8	01/1999 →
Audi TT	10/1998 →

④ 9EL 156 099-821

Opel Astra G	03/1998 →
Opel Zafira A	04/1999 →

⑤ 9EL 156 099-831

BMW 3 Series (E 30)	01/1983 → 12/1993
BMW 3 Series (E 36)	12/1990 → 09/1996
BMW 5 Series (E 28)	09/1981 → 12/1987
BMW 5 Series (E 34)	01/1988 → 03/1997
BMW 6 Series (E 24)	05/1976 → 04/1990
BMW 7 Series (E 32)	10/1986 → 05/1994



LED auxiliary indicator

Auxiliary indicator

using LED technology, adhesive mounting to prepared mirror or on wing.

12 V ECE/SAE 2BM 008 771-001

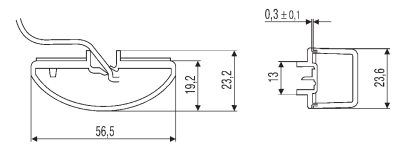

Side marker lights

Europe-wide approval for road traffic

Side marker lights from Hella make your vehicle easier to recognise from the side, thus increasing your safety during night-time trips. During the day the focus is on the innovative design of the lights.

A clear view through the clear, pattern-free lens of the advanced high-performance LED lighting technology. Waterproof. TÜV approval not required. ECE and SAE tested.

Side marker lights

12 V – with LED technology

Set (in packs of 4)

amber	2PS 008 138-801
silver	2PS 008 138-821
black	2PS 008 138-811

Individual lights

amber	2PS 008 138-001
silver	2PS 008 138-111
black	2PS 008 138-101

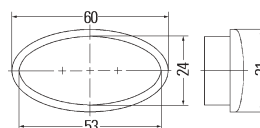

Premium rearlight modules

Light modules with a completely new design. Development work has resulted not only in an innovative appearance but a particularly homogeneous signal image as well.

Reflector with high-grade facet optics. Clear, pattern-free cover lens. Bulb socket at a 90° angle reduces the installation depth required. The bracket concept makes it possible to screw the lights in place invisibly from the rear. Optional adapter for mounting from the front.

Rearlight Ø 60 mm

with pre-fitted bulbs, 12 V

④ Taillight	ECE	2SA 009 001-041
④ Stoplight	ECE	2DA 009 001-051
④ Combined tail/stoplight	ECE	2SB 009 001-061
① Indicator	ECE	2BA 009 001-001
② Indicator		
with silver-coloured bulb, 12 V	ECE	2BA 009 001-191
④ Rear fog light	ECE	2NE 009 001-021
③ Reverse light	ECE	2ZR 009 001-011

with pre-fitted bulbs 24 V

④ Taillight	ECE	2SA 009 001-137
④ Stoplight	ECE	2DA 009 001-147
④ Combined tail/stoplight	ECE	2SB 009 001-157
① Indicator	ECE	2BA 009 001-107
④ Rear fog light	ECE	2NE 009 001-127
③ Reverse light	ECE	2ZR 009 001-117

Macro-reflector

⑤ Macro-reflector	ECE	8RA 009 001-031
-------------------	-----	-----------------



Premium circular modules

New!

The optimum range complement for Premium light modules. Versatile LED light ring with combined tail/stoplight function. The circular module is available either with a clear or red cover lens. There are 3 colour combinations possible to match individual tastes. Transparent, red or grey/red. The lights are mounted by means of screw attachment on the rear. The rings have been designed for attachment to the light modules of the series 009 001. An optional mounting ring fixes the lights in place with 2 screws. With 3-channel waterproof Superseal connector.

LED circular combined tail/stoplight

12 V

① Red lens	ECE	2SB 009 362-041
② Clear lens (with optional Design ring)	ECE	2SB 009 362-021

24 V

① Red lens	ECE	2SB 009 362-011
------------	-----	-----------------

Examples of possible combinations

③ With red lens and indicator

2SB 009 362-041 and 2BA 009 001-191

④ With red lens, reflector and silver Design ring (in operation)

2SB 009 071-041, 8RA 009 001-031 and 9HB 163 085-001

⑤ With a clear lens and macro-reflector

2SB 009 071-041 and 8RA 009 001-031

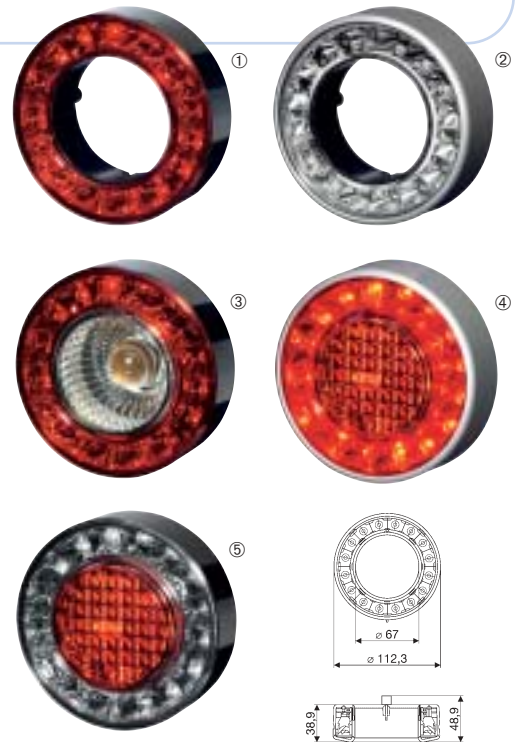

55 mm rearlight modules

Individual function for maximum design freedom. Ideal for combining with the circular modules. Individual multi-module look. ECE type-approved.

Combination rearlights

12 V and 24 V, for flush-fitting

① Taillight

without bulb 2XA 008 221-021

with pre-fitted bulb 12 V / 5 W 2SA 008 221-127

Stoplight

without bulb 2XA 008 221-021

with pre-fitted 12 V/21 W bulb 2DA 008 221-167

② Indicator with smoked glass

without bulb 2BA 008 221-041

with pre-fitted amber 12 V/21 W bulb 2BA 008 221-147

③ Rear fog light

without bulb 2NE 008 221-031

with pre-fitted 12 V/21 W bulb 2NE 008 221-137

④ Reverse light with smoked glass

without bulb 2ZR 008 221-051

with pre-fitted 12 V/21 W bulb 2ZR 008 221-157

Harness with grommet 8KA 152 134-007

Grommet separately 9GT 137 236-007

55 mm

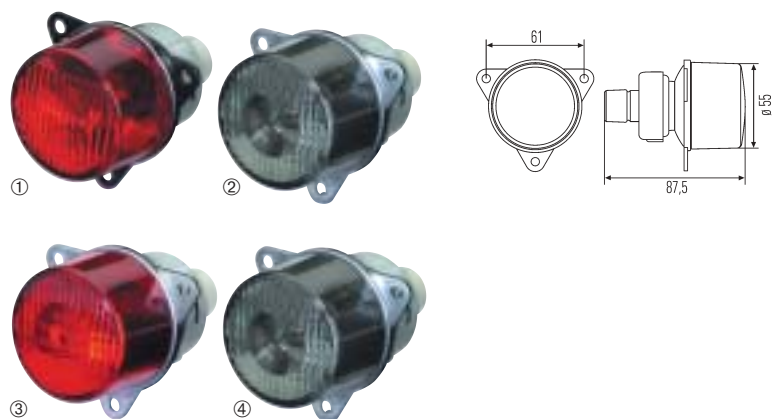

Circular modules

① Chrome-plated circular trim

for flush-fitting 8XU 008 405-031

② LED circular combined tail/clearance light

for flush-fitting 12 V 2SA 008 405-021

for flush-fitting 24 V 2SA 008 405-011

② LED circular ring combined tail/stoplight

12 V 2SB 008 405-101

24 V 2SB 008 405-091

③ Circular reflector

for flush-fitting 8RA 008 405-001

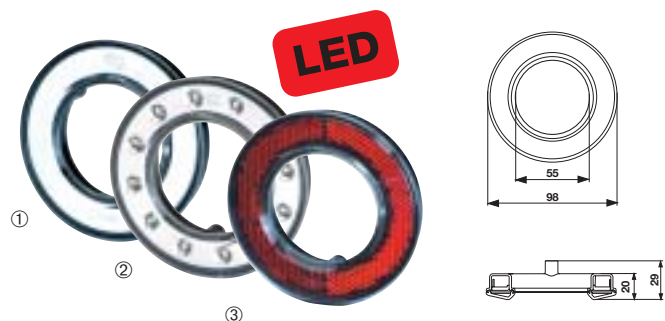

Examples of possible combinations

① Rear lighting

2BA 008 221-041 and 2SA 008 405-021

② Rear lighting

2XA 008 221-021 and 8RA 008 405-001

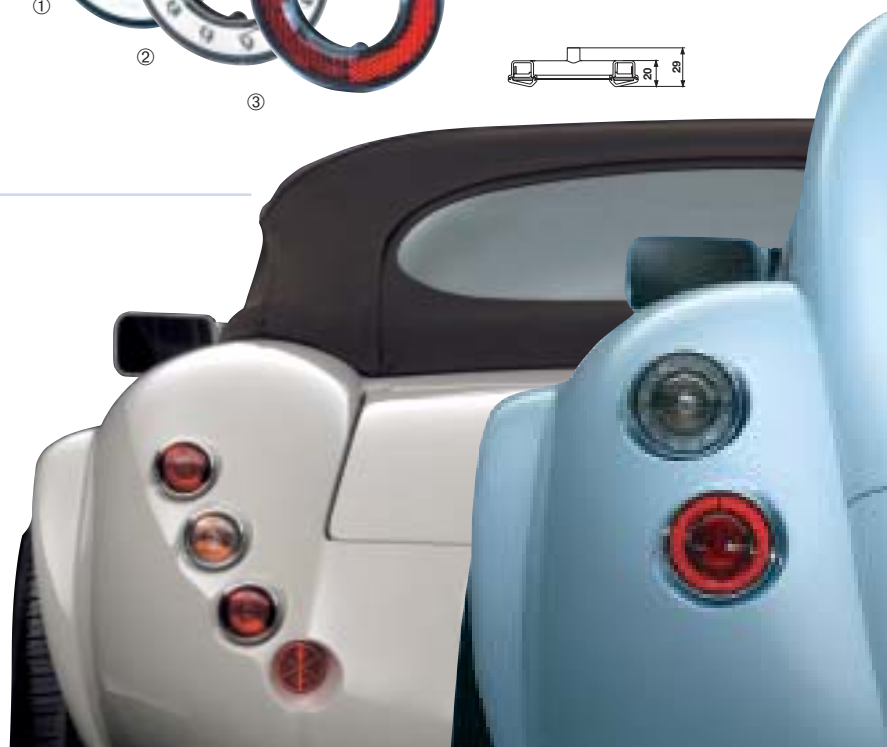
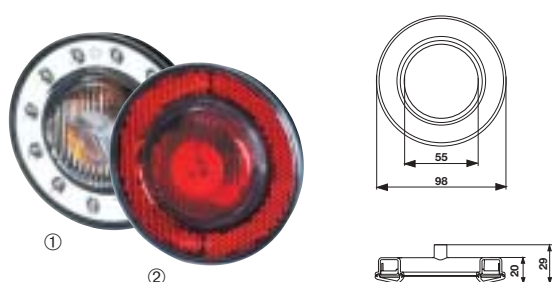

Safety stoplights

The great gain in safety for a wide range of different mounting situations.
With LED or matrix design.

Additional stoplight

LED

for flush-fitting, with 20 LEDs

Fastening from the outside 2DA 007 858-037

Harness with flat receptacles and grommet

(order separately) 8KA 146 751-007

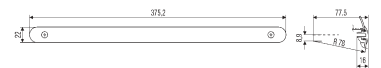

Additional stoplight

for flush-fitting

Fastening from the inside 2DA 008 136-007

With seal 2DA 008 136-027

Additional stoplight for flush-fitting

Fastening from the outside 2DA 008 136-011

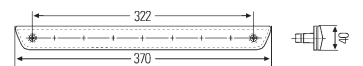

Additional stoplight

LED

for flush-fitting

Red light strip, 12 V 2DA 959 071-537

Smoked glass lens, 12 V 2DA 959 071-037

Red light strip, 24 V 2DA 959 071-737

Smoked glass lens, 24 V 2DA 959 071-237

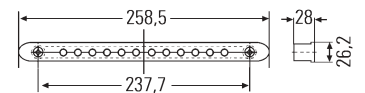

... and ECE regulations

Side

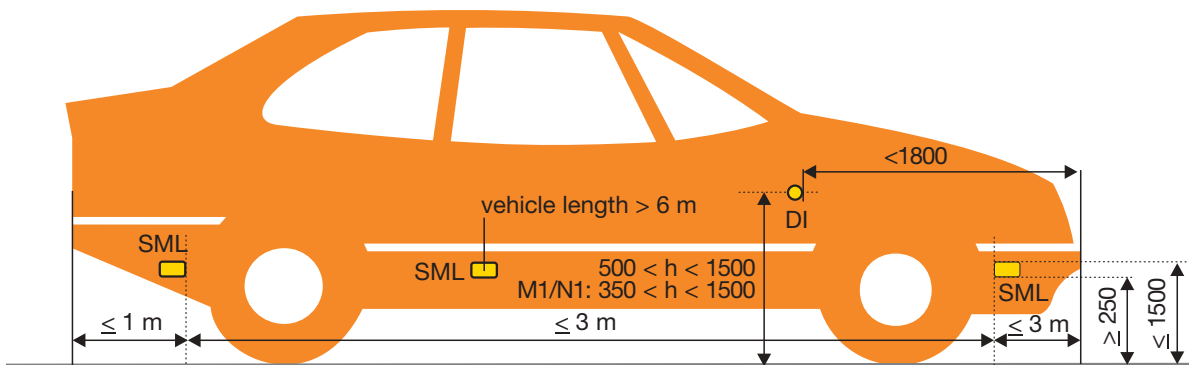

Type	Number (min./max.)	Colour
DI	1 per side	amber
SML front	1 per side	amber
SML rear	1 per side	amber or red

Vehicle categories

Valid for front, rear and side

M1	up to 3.5 t/9 persons
M2	up to 5.0 t/9 persons
M3	> 5.0 t/9 persons

Transportation of goods

N1	3.5 t
N2	3.5 t - 12 t
N3	> 12 t
N3G	Off-road vehicles

Trailers

O1	up to 0.75 t
O2	0.75 t - 3.5 t
O3	3.5 t - 10 t
O4	10 t

Side

DI = Side-mounted indicator
SML = Side marker light

ECE

Technical lighting equipment in accordance with ECE regulation 48

Accessories

Premium headlight modules



Carrier frame (not for halogen spotlights)

- ① without headlight range adjustment holder 9AH 161 786-017
- ② with headlight range adjustment holder 9AH 161 784-017

Plastic cap

for fog lights 9HD 149 253-007



Rubber cap

- ① for halogen low beam headlights 9GH 152 654-007
- ② for fog lights 9GH 147 009-007



Connector plug set

for plastic cap (20 pieces) 8JD 156 150-807



Servomotors for headlight range adjustment

- for 12 V halogen headlights 6NM 007 282-221
- for 12 V halogen headlights 6NM 007 282-231
- for 24 V halogen headlights 6NM 008 299-501

90 mm headlight modules



Rubber cap

for halogen low beam and spotlights

- flat design 9GH 152 654-007
- deep design 9GH 145 943-001



Rubber cap

for fog lights 9GH 158 051-007



Connector plug set

for position light

for 20 headlights 8JD 156 150-807



Connector plug set

for Xenon ballasts,

for 20 headlights 8JD 156 151-807



Connector plug set

for USA version

for 20 headlights 8JD 158 175-807

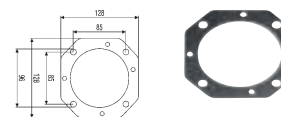

Carrier frame

for low beam and spotlights 9AH 157 659-007



Servomotors for headlight range adjustment

- for 12 V halogen headlights 6NM 007 282-221
- for 12 V xenon headlights 6NM 007 282-231
- for 24 V halogen headlights 6NM 008 299-501



Premium light modules

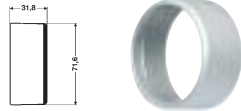

Design ring

silver-coloured 9HB 161 122-007

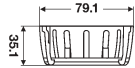

Design ring (matches the Premium light modules)

silver-coloured 9HB 164 168-002



Adapter ring – to be screwed on from the front

black 9XD 161 119-007



Snap-on ring for mounting from the front

silver-coloured 8HG 162 530-007



Connector plug set

2-pole (20 pieces) 8JD 156 150-007

3-pole (20 pieces) 8JD 162 581-002

55/60 mm light modules

Harness with grommet 8KA 152 134-007

Grommet 9GT 137 236-007

Premium LED combined tail/stoplight



Design ring

silver-coloured 9HB 163 085-001

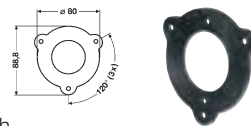

Adapter ring for mounting with

Macro-reflector 9XD 161 119-017

Light model series 009 001-... 9XD 161 119-007

Superseal 3-pole connection plug (not illustrated)

10 socket housings 8JA 746 184-032

50 pin contacts 1.0 - 1.5 mm 8KW 744 837-002

50 individual conductor seals 1.8 - 2.4 mm 9GD 746 185-002

50 blind plugs (for unused contacts) 9GD 746 187-002





© Hella KGaA Hueck & Co., Lippstadt 9Z2 999 121-584 FR/08.05/2.7 Printed in Germany

Hella KGaA Hueck & Co.
Rixbecker Straße 75
59552 Lippstadt, Germany

Phone: +49 (0) 29 41-38-0
Fax: +49 (0) 29 41-38-71 33
Internet: www.hella.com



**Ideas today for
the cars of tomorrow**