



Ideas today for
the cars of tomorrow

Product News

Latest Additions to the Hella Australia Range

03/09

New DuraLed® High Efficacy LED Task Lamps

High intensity and energy efficient general area lighting

Hella has launched a new range of universal, high intensity and ultra energy efficient DuraLed® LED Lamps offering the industry benchmark highest lumen per watt efficacy for a variety of applications.

LED lighting offers a number of decisive advantages over conventional globe technology that are beneficial for general and work area lighting. The new DuraLed® High Efficacy LED Lamps consume as little as 5 watts of power for minimal strain on both alternator and battery.

In addition to significantly reduced current draw, the highly efficient, low temperature LED circuit design ensure ultra long service life and extremely low degradation of performance.

Equipped with precision optics and the most powerful LEDs available to date, DuraLed® High Efficacy LED Lamps provide exceptional white light output and optimum light distribution for significantly improved work safety and reduced fatigue.

DuraLed® High Efficacy LED Lamps offer superior functional safety and operating reliability. Unlike halogen globes, LEDs are resistant to shock and vibration and last a minimum of 10,000 hours, eliminating the risk of sudden light failure during lamp operation.

The lens is manufactured from ultra-durable Grilamid® nylon, a revolutionary high-performance clear polyamide developed and manufactured in Switzerland, for extreme impact, UV, chemical and stress resistance.

DuraLed® High Efficacy LED Lamps are fully sealed against dust and moisture ingress and available in a range of output intensities and beam patterns: narrow, pencil and spread beam, to suit every individual lighting requirement.

Key Features

- Industry benchmark highest lumen per watt efficacy
- Ultra low power consumption (between 5W and 12W)
- Multivolt™ 9-33V DC
- Grilamid® nylon lens for extreme durability
- Low temperature LED circuit design
- Precision optics for optimum light distribution
- Available in narrow, pencil and spread beam patterns



:: Mega Beam Series

1539LED

Gen II LED FF Work Lamp - Close Range - 9-33V DC



Description The Generation II Mega Beam LED Work Lamp provides vastly improved light output, which has been increased from 180 to 550 lumen. Equipped with 4 high-performance white LEDs (6500°K), high-sheen metallised free-form (FF) reflector and clear glass lens for a consistent close-range illumination.

Voltage Multivolt™ (9-33V DC)

Wattage 15W

Mounting Stainless steel pedestal bracket for upright, side or pendant mounting.

Lead Length 2 metres

Temperature Range -40°C to +50°C

Protection

Reverse Polarity and Transient Voltage Suppressor (TVS). Fully sealed against dust and moisture to IP6K7 and IP6K9K.

Gen II Mega Beam LED 2.0m high at 10°

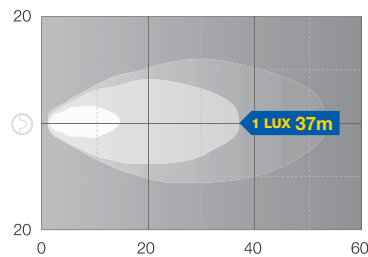

9.1517.08

HM8161

Accessory & Spare Part

HM8161 Clear Protective Cover

9.1517.08 Universal stainless steel pedestal bracket

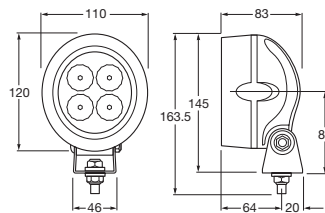

:: Module 70 Series

Gen II LED FF Work Lamp - Close Range - 9-33V DC

1547LED

Description	The Generation II Module 70 LED Work Lamp provides vastly improved light output, which has been increased from 180 to 550 lumen. Equipped with 4 high-performance white LEDs (6500°K), high-sheen metallised free-form (FF) reflector and clear glass lens for a consistent close-range illumination.
Voltage	Multivolt™ (9-33V DC)
Wattage	15W
Mounting	Stainless steel pedestal bracket for upright, side or pendant mounting.
Lead Length	2 metres
Temperature Range	-40°C to +50°C
Protection	Reverse Polarity and Transient Voltage Suppressor (TVS). Fully sealed against dust and moisture to IP6K7 and IP6K9K.



Gen II Module 70 LED 2.0m high at 10°

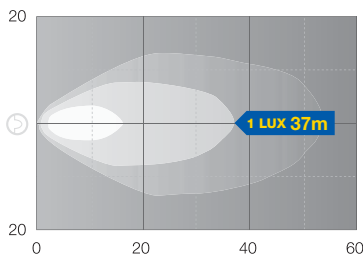

Accessories & Spare Part

HM70PR	Pipe mount tube attachment (rotating)
HM70PI	Pipe mount tube attachment
9.HM70BR	Module 70 stainless steel bracket
9.1517.08	Universal stainless steel pedestal bracket

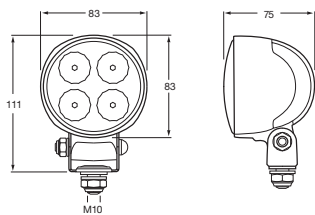

:: DuraLed® Series

98060400

DuraLed® Universal High Efficacy 50 LED Spread Beam Lamp - White Housing

98060403

DuraLed® Universal High Efficacy 50 LED Spread Beam Lamp - Charcoal Housing



White Housing



Charcoal Housing

Description High intensity spread beam LED lamp for general area or interior lighting. Equipped with 50 high efficacy LEDs for superior white light output rated at 1000 lumen, the industry benchmark for lumen per watt efficacy. Ultra-durable spread beam optic Grilamid® nylon lens for extreme impact, UV, chemical and stress resistance. Fully sealed to withstand high-pressure washing.

Voltage Multivolt™ (9-33V DC)

Wattage < 12W

Mounting Surface mount (mounting bushes included)

Lead Length 2.5 metres

Protection Reverse polarity and transient spike circuit protected. Fully sealed against dust and moisture to IP6K6 and IP6K7.

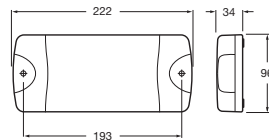

95903720

DuraLed® Universal High Efficacy 36 LED Spread Beam Lamp - White Housing

95903721

DuraLed® Universal High Efficacy 36 LED Spread Beam Lamp - Charcoal Housing



White Housing



Charcoal Housing

Description High intensity spread beam LED lamp for general area or interior lighting. Equipped with 36 high efficacy LEDs for superior white light output rated at 700 lumen, the industry benchmark for lumen per watt efficacy. Ultra-durable spread beam optic Grilamid® nylon lens for extreme impact, UV, chemical and stress resistance. Fully sealed to withstand high-pressure washing.

Voltage Multivolt™ (9-33V DC)

Wattage < 9W

Mounting Surface mount (mounting bushes included)

Lead Length 2.5 metres

Protection Reverse polarity and transient spike circuit protected. Fully sealed against dust and moisture to IP6K6 and IP6K7.

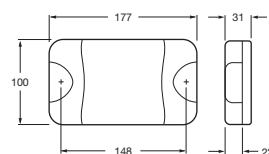

:: DuraLed® Series

DuraLed® Universal High Efficacy 36 LED Pencil Beam Lamp - White Housing

95903730

DuraLed® Universal High Efficacy 36 LED Pencil Beam Lamp - Charcoal Housing

95903731

Description High intensity pencil beam LED lamp for general area or interior lighting. Equipped with 36 high efficacy LEDs for superior white light output rated at 700 lumen, the industry benchmark for lumen per watt efficacy. Ultra-durable pencil beam optic Grilamid® nylon lens for extreme impact, UV, chemical and stress resistance. Fully sealed to withstand high-pressure washing.

Voltage Multivolt™ (9-33V DC)

Wattage < 9W

Mounting Surface mount (mounting bushes included)

Lead Length 2.5 metres

Protection Reverse polarity and transient spike circuit protected. Fully sealed against dust and moisture to IP6K6 and IP6K7.

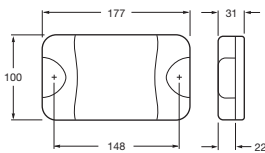

White Housing



Charcoal Housing

DuraLed® Universal High Efficacy 36 LED Narrow Beam Lamp - White Housing

95903740

DuraLed® Universal High Efficacy 36 LED Narrow Beam Lamp - Charcoal Housing

95903741

Description High intensity narrow beam LED lamp for general area or interior lighting. Equipped with 36 high efficacy LEDs for superior white light output rated at 700 lumen, the industry benchmark for lumen per watt efficacy. Ultra-durable narrow beam optic Grilamid® nylon lens for extreme impact, UV, chemical and stress resistance. Fully sealed to withstand high-pressure washing.

Voltage Multivolt™ (9-33V DC)

Wattage < 9W

Mounting Surface mount (mounting bushes included)

Lead Length 2.5 metres

Protection Reverse polarity and transient spike circuit protected. Fully sealed against dust and moisture to IP6K6 and IP6K7.

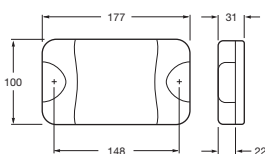

White Housing



Charcoal Housing

:: DuraLed® Series

98060801

DuraLed® Plus Universal High Efficacy 20 LED Spread Beam Lamp - White Housing



Description High intensity spread beam LED lamp for general area or interior lighting. Equipped with 20 high efficacy LEDs for superior white light output rated at 400 lumen, the industry benchmark for lumen per watt efficacy. Diffused optic acrylic lens for enhanced impact strength and improved tolerance to chemicals. Fully sealed to withstand high-pressure washing.

Voltage Multivolt™ (9-33V DC)

Wattage < 5W

Mounting Surface mount (mounting bushes included)

Lead Length 2.5 metres

Protection Reverse polarity and transient spike circuit protected.
 Fully sealed against dust and moisture to IP6K6 and IP6K7.

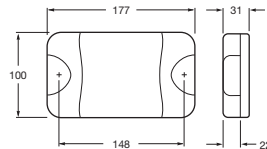

:: Strip LED Interior Lamps

2641HB-12V

High Efficacy LED Interior Lamp - White - 12V DC

2641HB-24V

High Efficacy LED Interior Lamp - White - 24V DC



Description High brightness LED strip lamp ideal for steps, storage areas, general interior and exterior courtesy lighting. Equipped with high efficacy LEDs for superior white light output rated at 200 lumen, 300% brighter than the standard equivalent. Clear acrylic lens for enhanced impact strength and improved tolerance to chemicals. Perimeter sealing gasket for neat panel fit. Shallow mounting depth allows easy installation.

Voltage 12V DC
 24V DC

Wattage 2W

Mounting Flush mount (gasket, screws and screw caps included)

Lead Length 2.5 metres

Protection Reverse polarity protected

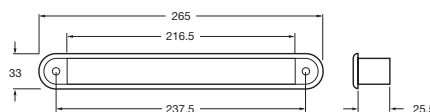

:: Latest Additions to the Hella Australia Range

:: LED Front Direction Indicators

LED Front Direction Indicator - Amber (Set of 2)	ADR	2107
LED Front Direction Indicator - Amber (Pack of 1)	 ADR	2107BL
LED Front Direction Indicator - Amber (Pack of 10)	ADR	2107BULK

Description	Compact, low profile LED Front Direction Indicator fitted with amber polycarbonate lens. Fully sealed to withstand high-pressure washing.
Voltage	Multivolt™ (9-33V DC)
Wattage	4W
Mounting	Flush mount (incorporates single stainless steel mounting bolt)
Lead Length	2.5 metres
Protection	Reverse Polarity and 5.0kW Transient Voltage Suppressor (TVS). Fully sealed against dust and moisture to IP6K6 and IP6K7.
ADR	Fully compliant with 3 rd Edition ADR 6/00 Cat. 1 Front Direction Indicator Lamp (CRN 41601).

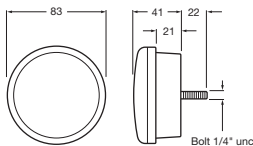

LED Front Direction Indicator - Amber Illuminated (Set of 2)	ADR	2107CLR
LED Front Direction Indicator - Amber Illuminated (Pack of 1)	 ADR	2107CLRBL
LED Front Direction Indicator - Amber Illuminated (Pack of 10)	ADR	2107CLRBULK

Description	Compact, low profile LED Front Direction Indicator fitted with clear polycarbonate lens. Fully sealed to withstand high-pressure washing. Optic appears clear until illuminated.
Voltage	Multivolt™ (9-33V DC)
Wattage	4W
Mounting	Flush mount (incorporates single stainless steel mounting bolt)
Lead Length	2.5 metres
Protection	Reverse Polarity and 5.0kW Transient Voltage Suppressor (TVS). Fully sealed against dust and moisture to IP6K6 and IP6K7.
ADR	Fully compliant with 3 rd Edition ADR 6/00 Cat. 1 Front Direction Indicator Lamp (CRN 41609).

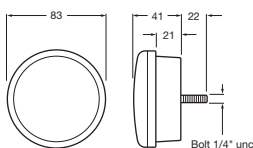

:: LED Front Direction Indicators

2106-CS

500 Series HCS LED Front Position Lamp & Front Direction Indicator Module - Amber Illuminated

ADR



Description Low profile LED Front Direction Indicator and Front Position Lamp Module specifically designed for commercial transport applications. Features Hella patented control technology HCS (Hella Compatibility Solution) ensuring seamless communication with LED compatible flasher units. Equipped with high-intensity LEDs and clear polycarbonate lens for superior light output and impact resistance. Designed to upgrade existing Front Direction Indicators 2128, 2135 and 2136. Fully sealed to withstand high-pressure washing. **Direction Indicator optic appears clear until illuminated.**

Voltage Multivolt™ (9-33V DC)

Wattage 8W

Mounting Flush mount (3 x mounting screws and screw caps included)

Lead Length 20 centimetres

Protection Reverse Polarity and 1.5kW Transient Voltage Suppressor (TVS). Sealed against dust and water ingress.

ADR/ECE Fully compliant with ECE and 3rd Edition ADR 6/00 Cat. 1 Front Direction Indicator Lamp (1 01 E24 5851) and ADR 49/00 Front Position Lamp (A 02 E24 5851).

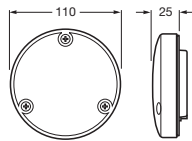

2131-CS

500 Series HCS LED Front Position Lamp & Front Direction Indicator - Amber Illuminated · Black Housing

ADR



Description LED Front Direction Indicator and Front Position Lamp fitted with high-intensity HCS LED module, Part No. 2106-CS, and black base. Features Hella patented control technology HCS (Hella Compatibility Solution) ensuring seamless communication with LED compatible flasher units. Fully sealed to withstand high-pressure washing. **Direction Indicator optic appears clear until illuminated.**

Voltage Multivolt™ (9-33V DC)

Wattage 8W

Mounting Surface mount (seals, grommets, screws and screw caps included)

Lead Length 20 centimetres

Protection Reverse Polarity and 1.5kW Transient Voltage Suppressor (TVS). Sealed against dust and water ingress.

ADR/ECE Fully compliant with ECE and 3rd Edition ADR 6/00 Cat. 1 Front Direction Indicator Lamp (1 01 E24 5851) and ADR 49/00 Front Position Lamp (A 02 E24 5851).

Spare Parts

2106-CS HCS LED Module, Amber illuminated
9.2397.40 Lens gasket

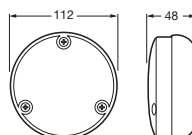

:: LED Front Direction Indicators

500 Series HCS LED Front Position Lamp & Front Direction Indicator - Amber Illuminated · Chrome Housing

ADR

2132-CS

Description LED Front Direction Indicator and Front Position Lamp fitted with high-intensity HCS LED module, Part No. 2106-CS, and chromed rim. Features Hella patented control technology HCS (Hella Compatibility Solution) ensuring seamless communication with LED compatible flasher units. Fully sealed to withstand high-pressure washing. **Direction Indicator optic appears clear until illuminated.**

Voltage Multivolt™ (9-33V DC)

Wattage 8W

Mounting Surface mount (seals, grommets, screws and screw caps included)

Lead Length 20 centimetres

Protection Reverse Polarity and 1.5kW Transient Voltage Suppressor (TVS). Sealed against dust and water ingress.

ADR/ECE Fully compliant with ECE and 3rd Edition ADR 6/00 Cat. 1 Front Direction Indicator Lamp (1 01 E24 5851) and ADR 49/00 Front Position Lamp (A 02 E24 5851).



Spare Parts

2106-CS HCS LED Module, Amber illuminated
9.2397.40 Lens gasket

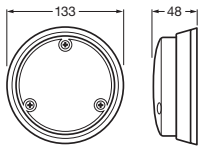

500 Series HCS LED Front Direction Indicator Module - Amber

ADR

2105-CS

Description Low profile LED Front Direction Indicator Module specifically designed for commercial transport applications. Features Hella patented control technology HCS (Hella Compatibility Solution) ensuring seamless communication with LED compatible flasher units. Equipped with high-intensity LEDs and amber polycarbonate lens for superior light output and impact resistance. Designed to upgrade existing Front Direction Indicators 2128, 2135 and 2136. Fully sealed to withstand high-pressure washing.

Voltage Multivolt™ (9-33V DC)

Wattage 8W

Mounting Flush mount (3 x mounting screws and screw caps included)

Lead Length 20 centimetres

Protection Reverse Polarity and 1.5kW Transient Voltage Suppressor (TVS). Sealed against dust and water ingress.

ADR/ECE Fully compliant with ECE and 3rd Edition ADR 6/00 Cat. 1 Front Direction Indicator Lamp (1 01 E24 0023).

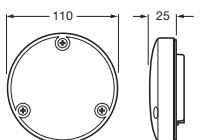

:: LED Front Direction Indicators

2135LED-CS

500 Series HCS LED Front Direction Indicator - Amber · Black Housing

ADR



Description LED Front Direction Indicator fitted with high-intensity HCS LED module, Part No. 2105-CS, and black base. Features Hella patented control technology HCS (Hella Compatibility Solution) ensuring seamless communication with LED compatible flasher units. Fully sealed to withstand high-pressure washing.

Voltage Multivolt™ (9-33V DC)

Wattage 8W

Mounting Surface mount (seals, grommets, screws and screw caps included)

Lead Length 20 centimetres

Protection Reverse Polarity and 1.5kW Transient Voltage Suppressor (TVS). Sealed against dust and water ingress.

ADR/ECE Fully compliant with ECE and 3rd Edition ADR 6/00 Cat. 1 Front Direction Indicator Lamp (1 01 E24 0023).

Spare Parts

2105-CS HCS LED Module, Amber
9.2397.40 Lens gasket

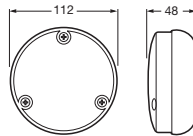

2136LED-CS

500 Series HCS LED Front Direction Indicator - Amber · Chrome Housing

ADR



Description LED Front Direction Indicator fitted with high-intensity HCS LED module, Part No. 2105-CS, and chromed rim. Features Hella patented control technology HCS (Hella Compatibility Solution) ensuring seamless communication with LED compatible flasher units. Fully sealed to withstand high-pressure washing.

Voltage Multivolt™ (9-33V DC)

Wattage 8W

Mounting Surface mount (seals, grommets, screws and screw caps included)

Lead Length 20 centimetres

Protection Reverse Polarity and 1.5kW Transient Voltage Suppressor (TVS). Sealed against dust and water ingress.

ADR/ECE Fully compliant with ECE and 3rd Edition ADR 6/00 Cat. 1 Front Direction Indicator Lamp (1 01 E24 0023).

Spare Parts

2105-CS HCS LED Module, Amber
9.2397.40 Lens gasket

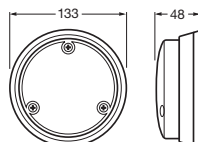

:: LED Front Direction Indicators

500 Series HCS LED Front Direction Indicator Module - Amber Illuminated

ADR

2105CLR-CS

Description Low profile LED Front Direction Indicator Module specifically designed for commercial transport applications. Features Hella patented control technology HCS (Hella Compatibility Solution) ensuring seamless communication with LED compatible flasher units. Equipped with high-intensity LEDs and clear polycarbonate lens for superior light output and impact resistance. Designed to upgrade existing Front Direction Indicators 2128, 2135 and 2136. Fully sealed to withstand high-pressure washing. **Optic appears clear until illuminated.**

Voltage	Multivolt™ (9-33V DC)
Wattage	8W
Mounting	Flush mount (3 x mounting screws and screw caps included)
Lead Length	20 centimetres
Protection	Reverse Polarity and 1.5kW Transient Voltage Suppressor (TVS). Sealed against dust and water ingress.
ADR/ECE	Fully compliant with ECE and 3 rd Edition ADR 6/00 Cat. 1 Front Direction Indicator Lamp (1 01 E24 0023).

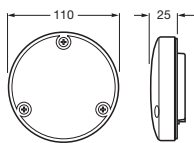

500 Series HCS LED Front Direction Indicator - Amber Illuminated - Black Housing

ADR

2135LEDCLR-CS

Description LED Front Direction Indicator fitted with high-intensity HCS LED module, Part No. 2105CLR-CS, and black base. Features Hella patented control technology HCS (Hella Compatibility Solution) ensuring seamless communication with LED compatible flasher units. Fully sealed to withstand high-pressure washing. **Optic appears clear until illuminated.**

Voltage	Multivolt™ (9-33V DC)
Wattage	8W
Mounting	Surface mount (seals, grommets, screws and screw caps included)
Lead Length	20 centimetres
Protection	Reverse Polarity and 1.5kW Transient Voltage Suppressor (TVS). Sealed against dust and moisture ingress.
ADR/ECE	Fully compliant with ECE and 3 rd Edition ADR 6/00 Cat. 1 Front Direction Indicator Lamp (1 01 E24 0023).



Spare Parts

2105CLR-CS	HCS LED Module, Amber illuminated
9.2397.40	Lens gasket

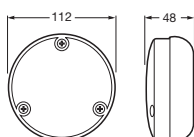

:: LED Front Direction Indicators

2136LEDCLR-CS

500 Series HCS LED Front Direction Indicator - Amber Illuminated · Chrome Housing

ADR



Description LED Front Direction Indicator fitted with high-intensity HCS LED module, Part No. 2105CLR-CS, and chromed rim. Features Hella patented control technology HCS (Hella Compatibility Solution) ensuring seamless communication with LED compatible flasher units. Fully sealed to withstand high-pressure washing.
Optic appears clear until illuminated.

Voltage	Multivolt™ (9-33V DC)
Wattage	8W
Mounting	Surface mount (seals, grommets, screws and screw caps included)
Lead Length	20 centimetres
Protection	Reverse Polarity and 1.5kW Transient Voltage Suppressor (TVS). Sealed against dust and water ingress.
ADR/ECE	Fully compliant with ECE and 3 rd Edition ADR 6/00 Cat. 1 Front Direction Indicator Lamp (1 01 E24 0023).

Spare Parts

2105CLR-CS	HCS LED Module, Amber illuminated
9.2397.40	Lens gasket

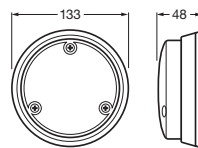

:: LED Rear Direction Indicators

2165-CS

500 Series HCS LED Rear Direction Indicator Module - Amber

ADR



Description Low profile LED Rear Direction Indicator Module specifically designed for commercial transport applications. Features Hella patented control technology HCS (Hella Compatibility Solution) ensuring seamless communication with LED compatible flasher units. Equipped with high-intensity LEDs and amber high-impact resistant acrylic lens with unique UWVO (ultra wide visibility optics) for significantly improved side visibility. Fully sealed to withstand high-pressure washing.

Voltage	Multivolt™ (9-33V DC)
Wattage	8W
Mounting	Flush mount (3 x mounting screws and screw caps included)
Lead Length	20 centimetres
Protection	Reverse Polarity and 1.5kW Transient Voltage Suppressor (TVS). Sealed against dust and water ingress.
ADR/ECE	Fully compliant with ECE and 3 rd Edition ADR 6/00 Cat. 2a Rear Direction Indicator Lamp (2a 01 E24 0023).

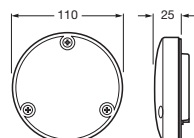

:: LED Rear Direction Indicators

500 Series HCS LED Rear Direction Indicator - Amber · Chrome Housing



2159-CS

Description	LED Rear Direction Indicator fitted with high-intensity HCS LED module, Part No. 2165-CS, and chromed rim. Features Hella patented control technology HCS (Hella Compatibility Solution) ensuring seamless communication with LED compatible flasher units. Fully sealed to withstand high-pressure washing.
Voltage	Multivolt™ (9-33V DC)
Wattage	8W
Mounting	Surface mount (seals, grommets, screws and screw caps included)
Lead Length	20 centimetres
Protection	Reverse Polarity and 1.5kW Transient Voltage Suppressor (TVS). Sealed against dust and water ingress.
ADR/ECE	Fully compliant with ECE and 3 rd Edition ADR 6/00 Cat. 2a Rear Direction Indicator Lamp (2a 01 E24 0023).



Spare Parts

2165-CS	HCS LED Module, Amber
9.2397.40	Lens gasket

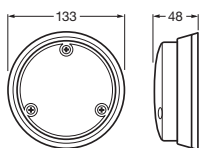

500 Series HCS LED Rear Direction Indicator - Amber · Black Housing



2167-CS

Description	LED Rear Direction Indicator fitted with high-intensity HCS LED module, Part No. 2165-CS, and black base. Features Hella patented control technology HCS (Hella Compatibility Solution) ensuring seamless communication with LED compatible flasher units. Fully sealed to withstand high-pressure washing.
Voltage	Multivolt™ (9-33V DC)
Wattage	8W
Mounting	Surface mount (seals, grommets, screws and screw caps included)
Lead Length	20 centimetres
Protection	Reverse Polarity and 1.5kW Transient Voltage Suppressor (TVS). Sealed against dust and water ingress.
ADR/ECE	Fully compliant with ECE and 3 rd Edition ADR 6/00 Cat. 2a Rear Direction Indicator Lamp (2a 01 E24 0023).



Spare Parts

2165-CS	HCS LED Module, Amber
9.2397.40	Lens gasket

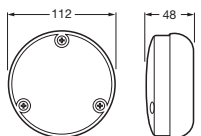

:: LED Side Marker Lamps

2058	HD LED Side Marker - Red/Amber Illuminated - Satin S/S Housing	ADR
2058BULK	HD LED Side Marker - Red/Amber Illuminated - Satin S/S Housing (Pack of 4)	ADR
2058P	HD LED Side Marker - Red/Amber Illuminated - Polished S/S Housing	ADR
2058PBULK	HD LED Side Marker - Red/Amber Illuminated - Polished S/S Housing (Pack of 4)	ADR



Satin Housing



Polished Housing

Description	Heavy-duty LED Side Marker featuring satin or polished stainless steel housing and ultra-durable Grilamid® nylon lens for extreme impact, UV, chemical and stress resistance.	
Voltage	Multivolt™ (8-28V DC)	
Wattage	12V DC	0.4W
	24V DC	0.8W
Mounting	Surface mount	
Lead Length	0.5 metre (display pack) 2.5 metres (bulk pack)	
Protection	Fully sealed against dust and moisture to IP6K6 and IP6K7.	
ADR	Fully compliant with 3 rd Edition ADR 45/01 Side Marker Lamp (CRN 41597).	

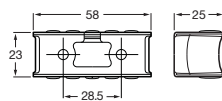

:: LED Courtesy & Marker Lamp Accessory



9GD959515207	Curved Narrow Rim Mounting Gasket
---------------------	--



Description	Curved seal for flush mounting narrow rim LED courtesy and marker lamps on curved surfaces. Designed to suit 64mm (2.5") pipes. Flexibility allows gasket to suit a variety of curve radii.
--------------------	---

:: Latest Additions to the Hella Australia Range

:: LED Warning Signal Lamps

Round MultiFLASH® Signal LED - Red	95901140	
Round MultiFLASH® Signal LED - Amber	95901145	
Round MultiFLASH® Signal LED - Blue	95901160	
Round MultiFLASH® Signal LED - Green	95901165	

Description High-intensity, signal optic LED Lamp with single bolt mount specifically designed for emergency services. Features 10 programmable flash modes and synchronisation function with variable offset.

Voltage Multivolt™ (9-33V DC)

Wattage 6W continuous (less in flashing modes)

Flash Rate Refer to MultiFLASH® patterns.

Mounting Flush mount (incorporates single stainless steel mounting bolt)

Lead Length 2.5 metres

Protection Reverse polarity and transient spike circuit protection.
Fully sealed against dust and moisture to IP6K6 and IP6K7.

EMC Approval  03 1681



MultiFLASH® Patterns

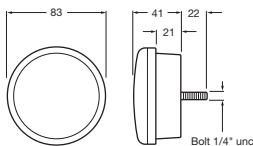
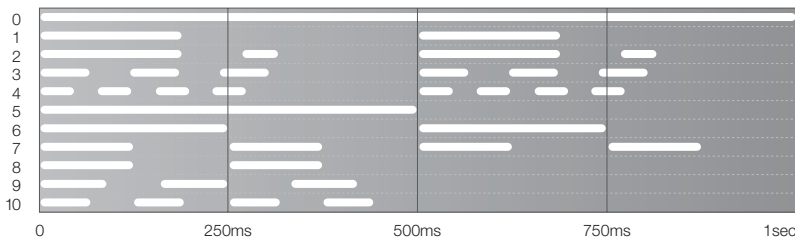



**Hella redefines the pinnacle.
The new iX Series with integral ballast.**

Pure **Xenon Gas Discharge** Performance without compromise, now with **in-body electronic ballast** so you can mount them where you want.

Only the **best**: The new **precision** die-cast housing and mounting system achieves both **high strength and light weight**. Precision **quality** glass lens and High-Boost Free Form (FF) reflector to output **maximum** light. Built for **heavy duty** use, 12V DC and 24V DC. **Pencil Beam** (1000m @ 1Lux) and **Spread Beam** versions available.

See your world in a new light.

Compromise gets you nowhere.



Above: **Predator** High Boost iX XGD Driving Lamp (12V DC Pencil & Spread Beam, 24V DC Spread Beam versions available), 220mm dia.

Left: **Rallye FF 4000** Compact iX Series (12V DC Pencil & Spread Beam version available), 170mm dia.



**Ideas today for
the cars of tomorrow**

Hella Australia Pty Ltd
Southern Road,
Mentone, Victoria, 3194
P.O. Box 89, Mentone, 3194

Telephone: (03) 9581 9333
Facsimile: (03) 9585 2654
Email: custservice@ha.hella.com
Web: www.hella.com.au

Hella Customer Service 1800 061 729

Special note: The illustrations, information and specifications presented and referred to in this leaflet were correct at the date of printing. However, Hella reserves the right, subject to all applicable laws, at any time, at its discretion and without notice, to discontinue or change the specifications or the design of any product referred to herein. The data and suggested applications are given as a general guide only and users should independently evaluate the suitability of each product for any particular application.