

UltraBeam FF Halogen Long Range Work Lamps



UltraBeam FF Halogen Long Range is a superior, compact heavy-duty work lamp for use on mining machinery suitable for both 24V and 12V electrical systems.

As part of our ongoing development program the latest addition to the UltraBeam FF range applies our most recent advances in free-form (FF) reflector technology with a clear lens and the popular H3 Halogen lamp to create a very compact long range work lamp for applications where the performance of a Xenon light is not required.

The very compact optics deliver excellent lighting under continuous use in the extreme environmental conditions encountered in mining applications. Electrical connection is facilitated via integrated AMP connector.

UltraBeam FF clear lens long range optical inserts are produced as a modular assembly of a precision die-cast specular reflector with integral lamp holder, permanently assembled to a corrosion resistant hardened clear glass

lens ensuring high efficiency and perfect focus of each unit. This new lens long range optical insert is available as a spare part and 100% compatible with older UltraBeam FF H3 work lamps to ensure simple on site maintenance and perfect retrofitting.

In common with the wider range of Hella UltraBeam FF work lamps the basic version of the patented MustADD® filter is included to ensure the optical system remains virtually dust free over the product life in the adverse atmospheres typically encountered in mining.

The supplied stainless steel mounting hardware is non-resonant and highly corrosion resistant. The UltraBeam FF features the integral DRACO® dampers in the bracket system to reduce the intensity of shock and vibration communicated to the light.

The UltraBeam FF family is based on very compact lamp housings moulded from a highly corrosion resistant, heavy-duty polymer body.

A lens retaining ring enables easy routine service access from the front, while high temperature O-ring seals ensure effective sealing.

Product Features

- Powerful long range and wide spread illumination
- AMP electrical connection
- Robust polymer body
- Stainless steel mounting bracket
- Draco® suspension
- Free-form (FF) reflector for powerful long range illumination
- MustADD® multi air-filter
- IP6K7
- O-ring seals
- Clear protective covers available

Specifications

Voltage	24V (H3 globe included)
Power Consumption	70W Max.
Mounting	Single bolt with tilt adjustment for upright, side or pendant mounting on horizontal or vertical surfaces. Stainless steel bracket and screws included.
Temperature Range	-40°C to +105°C
Protection	Sealed against dust and moisture to IP6K7. Shock resistant to 50G.

Description	Part No.
UltraBeam Work Lamp - 24V, H3	
Long Range AMP Plug	HMUBH03LRA

MUSTADD

DRACO

H3

AMP

0.0Kg

IP6K7

50G

24V

70W Max

Spare Parts

HM8158	Clear Protective Cover
HM8158AMBER	Clear Protective Cover - Amber
9.1533.03	Long Range Insert
YC2470	H3 Globe, 24V 70W
YC1255	H3 Globe, 12V 55W

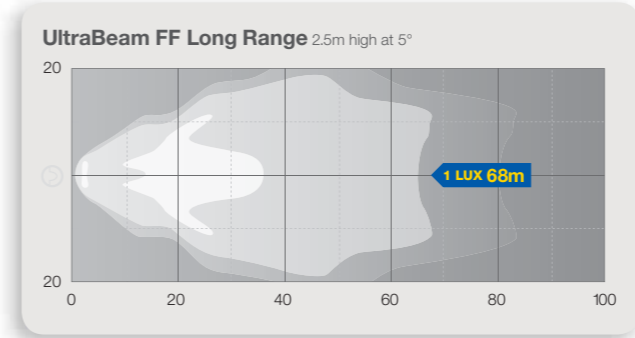
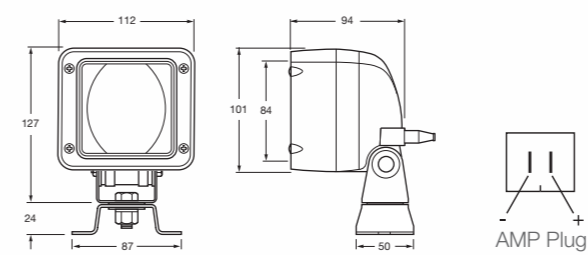

Front View

