



**Hella marine**  
Vision and Innovation

# Product News

Latest Additions to the Hella Marine Range

Issue 1

**NAViLED® 360**



## NavILED 360 Surface Mount ...the future of marine lighting

**New NavILED® 360 compact surface mount lamps feature single LED efficiency, advanced Multivolt™ electronics and precision engineered optics for reliable and highly visible all round lighting.**

Hella marine has introduced a new range of compact, surface mount all round lamps featuring power saving LED technology and robust base suitable for a variety of applications.

NavILED® 360 lamps draw a fraction of the energy required to operate a conventional 2 nautical mile globe type lamp. Designed and manufactured by Hella marine, NavILED® 360 lamps provide superior visibility and durability with less than 2 watt power consumption.

Hella marine LED technology has no filaments to break thus making the lamps extremely shock, vibration and impact resistant. They are completely maintenance free. High impact acrylic housings provide superior durability in demanding conditions.

NavILED® 360 navigation lamps have undergone extensive 'tested to destruction' programs to help increase product reliability to a new standard. Each lamp is a completely sealed and waterproof unit, UV and corrosion resistant.

Utilising advanced Multivolt™ circuitry, NavILED® 360 lamps provide consistent illumination and safety from 9-33V DC, even under severe voltage fluctuations and low battery voltages. Sealed within the base, the compact Multivolt™ drive circuitry provides reverse polarity, spike and over-voltage protection for long life and reliable operation.

NavILED® 360 lamps meet the requirements of IMO COLREG 72, NMSC, USCG, ABYC A-16 and RINA.



### Key Features

- Ultra low current draw
- Ultra long service life
- No globes - No maintenance
- Multivolt™ 9-33V DC
- Safe and highly visible
- Fully sealed
- UV and corrosion resistant
- Shock and vibration resistant
- Pre-wired
- Fit and Forget



## NaviLED® 360 Series



### Ultra durable and energy efficient LED All Round/ Navigation Lamps

- 2 Nautical Mile Visibility
- Less than 2W power consumption
- Completely sealed
- Shock and vibration resistant
- Multivolt™ 9-33V DC

NaviLED® 360 surface mount LED lamps provide safe, highly durable and ultra energy efficient all round lighting for a variety of applications on commercial and recreational vessels.

<b>Housing Description</b>	UV resistant, enhanced impact acrylic lens. Anodized aluminium lamp base.
<b>Minimum Visible Distance</b>	2 Nautical Miles
<b>Light Source</b>	Single LED
<b>Installation</b>	Pre-wired with marine cable.
<b>Operating Voltage</b>	Multivolt™ 9-33V DC
<b>Voltage Protection</b>	Spike protected to +500 volts Over voltage protected to +200 volts Reverse polarity protected to -500 volts
<b>Power Consumption</b>	Less than 2W
<b>Degree of Protection</b>	Completely sealed
<b>Approvals</b>	IMO COLREG, NMSC, USCG, RINA (I) and ABYC A-16

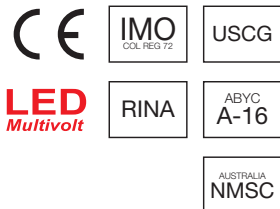

### 2 Nautical Mile NaviLED® 360 Surface Mount LED Lamps

Light Colour	Black Base	White Base	Qty
White	2LT 980 910-001	2LT 980 910-011	1
	2LT 980 910-007	2LT 980 910-017	10
Green	2LT 980 910-201	2LT 980 910-211	1
	2LT 980 910-207	2LT 980 910-217	10
Red	2LT 980 910-401	2LT 980 910-411	1
	2LT 980 910-407	2LT 980 910-417	10

**LED**  
Multivolt



2LT 980 910-411  
Red light, surface mount base, white

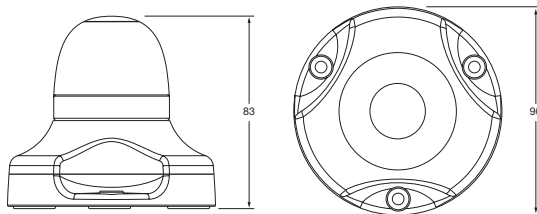

## Slimline Round Courtesy Lamps

### Hi-Intensity White LED Courtesy Lamps

- Concentrated light pattern
- 3 x the light output compared to standard versions
- 13mm mounting depth
- Ultra low power consumption
- Ultra long service life
- Shock and vibration resistant
- 12V DC and 24V DC

Advancing Hella marine LED and optic technology has allowed the introduction of Hi-Intensity Slimline round LED courtesy lamps.

Suitable for interior and exterior use, these Hi-Intensity versions feature a concentrated light pattern and three times the light output compared to standard Slimline LED lamps.

Hella marine LED lamps consume a fraction of the energy of traditional globe type lamps and run very cool due to their low current draw. This provides safer installation into light weight materials where excess heat could cause damage to the surrounding structure.

Hella marine LED courtesy lamps are completely sealed and waterproof, UV and corrosion resistant, making them the ideal lighting solution for demanding marine environments.



<b>Material Description</b>	UV and impact resistant plastic.
<b>Light Source</b>	4 LEDs
<b>Installation</b>	Pre-wired with 120mm cable.
<b>Operating Voltage</b>	12V DC or 24V DC
<b>Power Consumption</b>	0.5W
<b>Degree of Protection</b>	IP67
<b>Mounting</b>	Recess or surface mount. 3 stainless steel screws included.



#### Hi-Intensity Slimline Round LED Courtesy Lamps - White

Rim Colour	12V DC	24V DC	Qty
Polished S/S	2XT 980 500-521	2XT 980 501-521	1
	2XT 980 500-527	2XT 980 501-527	24
Gold Plated S/S	2XT 980 500-531	2XT 980 501-531	1
	2XT 980 500-537	2XT 980 501-537	24
White	2XT 980 500-541	2XT 980 501-541	1
	2XT 980 500-547	2XT 980 501-547	24
Black	2XT 980 500-551	2XT 980 501-551	1
	2XT 980 500-557	2XT 980 501-557	24



#### Hi-Intensity Slimline Round LED Courtesy Lamps - Warm White

Rim Colour	12V DC	24V DC	Qty
Polished S/S	2XT 980 500-721	2XT 980 501-721	1
	2XT 980 500-727	2XT 980 501-727	24
Gold Plated S/S	2XT 980 500-731	2XT 980 501-731	1
	2XT 980 500-737	2XT 980 501-737	24
White	2XT 980 500-741	2XT 980 501-741	1
	2XT 980 500-747	2XT 980 501-747	24
Black	2XT 980 500-751	2XT 980 501-751	1
	2XT 980 500-757	2XT 980 501-757	24

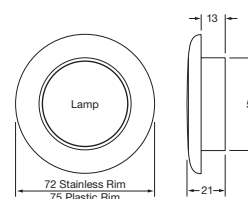



Hella marine

# Product News

## Easy Fit Courtesy Lamps



### Ultra compact, stylish and energy efficient LED Courtesy Lamps

- Ultra low power consumption
- Completely sealed
- Shock and vibration resistant
- Multivolt™ 12-24V DC

Hella marine Easy Fit LED courtesy lamps are suitable for a variety of interior and exterior lighting applications.

The light is radiated downward at an angle of 30° making these lamps the ideal solution for illuminating onboard areas such as steps, stairs, toe kicks, storage areas, companion ways, deck fittings, signs and switches.

Multivolt™ electronics ensure a consistent level of intensity in 12V DC or 24V DC systems. Like all Hella marine LED lamps, Easy Fit lamps are completely sealed, shock and vibration resistant and represent reliable 'fit and forget' technology.

<b>Housing Description</b>	UV and impact resistant acrylic.
<b>Light Source</b>	LED
<b>Installation</b>	Pre-wired with 100mm cable.
<b>Operating Voltage</b>	Multivolt™ 12-24V DC
<b>Power Consumption</b>	0.5W
<b>Degree of Protection</b>	Completely sealed
<b>Mounting</b>	Single hole. Foam gasket included.

### Easy Fit LED Step Lamps - Red Illuminated, Clear Lens

**LED**  
Multivolt

Cap Colour	12-24V DC	Qty
Chrome	2JA 998 560-201	1
White	2JA 998 560-211	1
Black	2JA 998 560-221	1
Gold	2JA 998 560-231	1

### Easy Fit LED Step Lamps - Amber Illuminated, Clear Lens

**LED**  
Multivolt

Cap Colour	12-24V DC	Qty
Chrome	2JA 998 560-301	1
White	2JA 998 560-311	1
Black	2JA 998 560-321	1
Gold	2JA 998 560-331	1

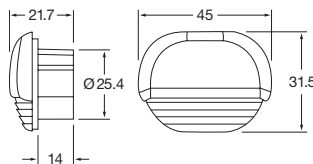

**Note:** Lamp covers cannot be easily removed once clipped into place.



**Hella marine**  
Vision and Innovation

Hella Australia Pty Ltd  
Southern Road,  
Mentone, Victoria, 3194  
P.O. Box 89, Mentone, 3194

Telephone: (03) 9581 9333  
Facsimile: (03) 9585 2654  
Email: [custservice@ha.hella.com](mailto:custservice@ha.hella.com)  
Web: [www.hella.com.au](http://www.hella.com.au)

**Hella Customer Service 1800 061 729**

Special note: The illustrations, information and specifications presented and referred to in this leaflet were correct at the date of printing. However, Hella reserves the right, subject to all applicable laws, at any time, at its discretion and without notice, to discontinue or change the specifications or the design of any product referred to herein. The data and suggested applications are given as a general guide only and users should independently evaluate the suitability of each product for any particular application.