

Light Dimmer



2 Group Light Dimmer

**Features:**

- Precise dimming control for 1 or 2 light groups
- Voltage regulation & 'soft-start' bulb protection
- Low voltage battery protection
- 12V and 24V DC

The Hella marine 2 Group Light Dimmer provides precise dimming control for one or two separate light groups, and sophisticated voltage regulation with a 'soft-start' feature to lengthen the life of a filament bulbs. The dimmer also provides low voltage protection against deep battery discharge.

When batteries are charged voltage can rise to 14.4V on 12V systems or 28.8V on 24V systems, this can shorten the life of bulbs. The 2 Group Dimmer increases bulb life through sophisticated internal voltage regulation, ensuring the lighting circuit voltage does not rise above 12V or 24V. As halogen bulbs also have a high inrush current on start up, the 2 Group Dimmer features 'soft-start' to further lengthen bulb life.

The dimmers low voltage protection also protects against deep battery discharge. Lights will turn off automatically when battery voltage is lower than 9V on a 12V system or lower than 18V on a 24V system. Lights can be switched on again when the battery is charged and reaches 12V or 24V respectively.

Max. Load	200W at 12V and 400W at 24V
Max. Load Per group	100W at 12V and 200W at 24V
Input Voltage Range	8 - 30V DC
System Voltage	12V or 24V DC
Number of Groups	2
Switches Per Group	Unlimited
Switch Type	Momentary normally open
Weight	140 grams
Protections	Overload, Temperature, Low voltage
Fuse	2 x 10A

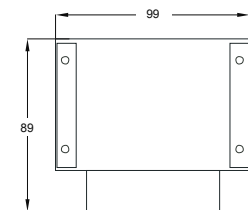

2 Group Light Dimmer

Part Number

5XA 998 572-001