



BRIEF INFORMATION

LED combination lamp CircLED 90

- › Three light functions in one module: Daytime running light, position light, direction indicator light (available in various combinations)
- › Particularly light and compact module with homogeneous light signature
- › Black framed, "floating" lens gives the vehicle front a modern, timeless design
- › For diverse applications and the highest demands

PRODUCT FEATURES

The new CircLED 90 combination lamp from HELLA combines three LED light functions in one module: daytime running light, position light and direction indicator light. Thanks to the compact design (90 mm) and low installation depth, the multi-function lamp can be easily mounted in the vehicle environment using an integrated screw dome. As required, it can also be combined with any HELLA front lighting product.

The optically floating lens embedded in a black ring gives the module a unique appearance. At the same time, the homogeneous light signature creates a modern and elegant front design.

The CircLED 90 is available with various light functions and is suitable for a wide range of applications with different requirements. The four integrated LEDs deliver maximum efficiency in a small space and offer a long service life.

Thanks to the protection classes IP 5K4K and IP 5K9K, the robust and lightweight module is waterproof, dustproof and resistant to high-pressure jet cleaning.

TECHNICAL DETAILS

Technical data

Operating voltage	Multi-voltage (9 – 32 V)
Rated voltage	12 V and 24 V
Current consumption	Daytime running light: 0.14 A (32 V) Position light: 0.035 A (32 V) Direction indicator light: 0.14 A (32 V)
Power consumption	Daytime running light: 5 W Position light: 1.5 W Direction indicator light: 5 W
Light function	Daytime running light, position light, direction indicator light (various light function combinations available)
Light source	LED
Material	Housing: Polycarbonate Lens: Polycarbonate
Weight	170 g
Temperature range	-40 °C to +60 °C
Protection class	IP 5K9K, IP 5K4K
Approved	ECE R148.01, FMVSS 108, CCC
Compliant	ECE-R10, CISPR 25 Class 5*
Mounting	With additional carrier frame and screws (back and front)
Connection	FEP or DEUTSCH connector

* In some frequency ranges, CISPR 25 Class 3.

Dimensional sketch

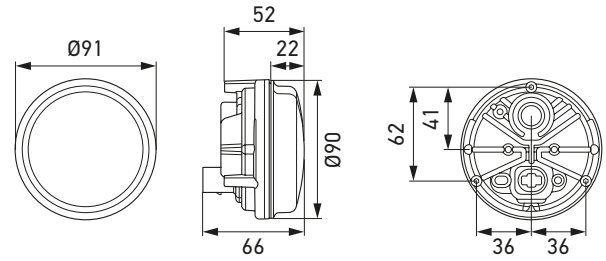

Pin assignment

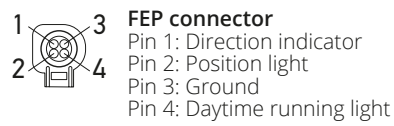

FUNCTIONS

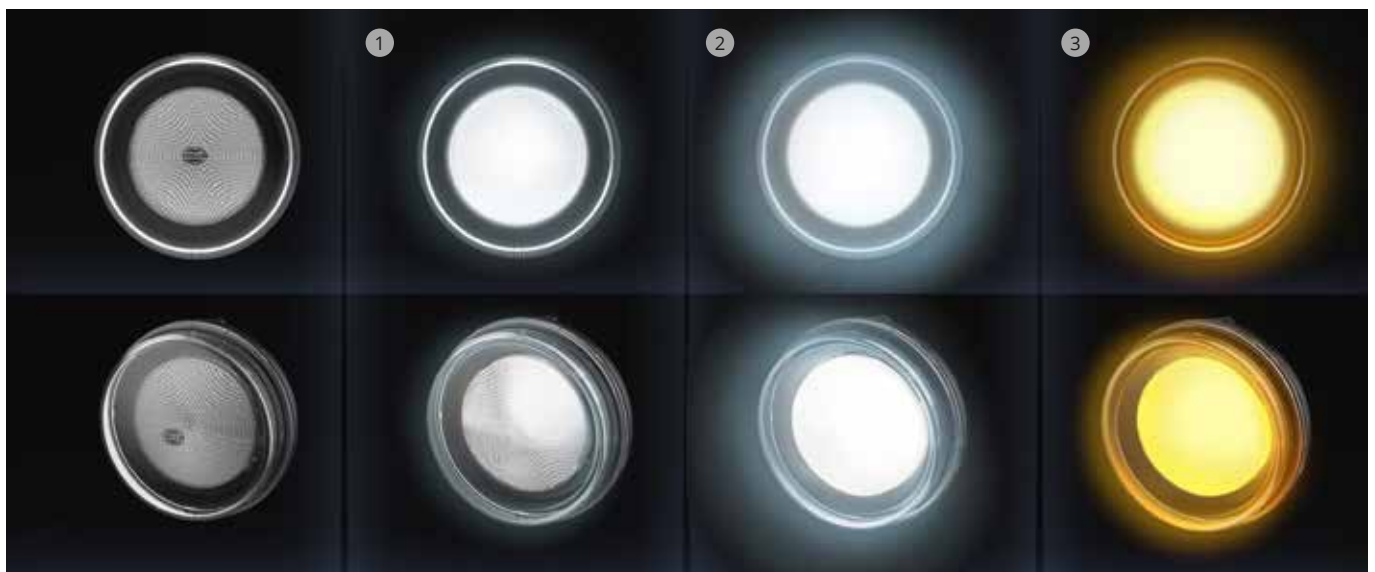

[1] Position light

[2] Daytime running light

[3] Direction indicator light

PROGRAM OVERVIEW

Product image	Type of mounting	Connection	Variant	Part number
	Screw mounting	FEP	Position light, daytime running light and direction indicator light, ECE	2BE 016 540-001
		DEUTSCH	Position light, daytime running light and direction indicator light, ECE	2BE 016 540-011
		DEUTSCH	Position light, daytime running light and direction indicator light, SAE	2BE 016 540-031
		DEUTSCH	Position light and daytime running light, ECE / SAE	2PT 016 540-111
		DEUTSCH	Position light and direction indicator light, ECE	2BE 016 540-211
		DEUTSCH	Position light and direction indicator light, SAE	2BE 016 540-231

ACCESSORIES

Description	Part number
Carrier frame group for screw mounting (carrier frame screwed from front or back) Includes carrier frame and 3 x PT screw Delta 4x12	9AH 274 969-001