



BRIEF INFORMATION

LED Auxiliary Direction Indicator, Cat. 5, 340 825

- › Excellent light diffusion
- › Extremely low energy consumption
- › Approval for dangerous goods transport according to ADR / GGVSEB

PRODUCT FEATURES

Quality by conviction

With the small dimensions and articulate optics, our Auxiliary Side Direction Indicator (Category 5) brings a plus to the safety feature of the vehicle at hand. The particularly developed optical lens system realizes an excellent light diffusion along the axis of the road, which enables the following traffic to clearly identify a turn reducing potential blind spots.

The small and round product architecture allows for a seamless integration into the vehicle body with effortless mounting. You have the option to choose from a polycarbonate and rubber housing, establishing the optimal contact to the car body shell. Electrical interface to your vehicle is possible to a variety of cabling and connector systems.

TECHNICAL DETAILS

Technical data

Operating voltage range	Single-voltage (9 – 16 V)
Rated voltage	12 V
Power consumption	0.7 W
Light function	Aux. direction indicator
Temperature range	-40 °C to +50 °C
Protection class	IP 6K6X
Approved	ECE-R7, ADR / GGVSEB
Specification	HN 67101 3.1 and 7.1
Mounting	Side-mounted

Technical drawing and hole pattern

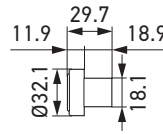

Plastic Housing

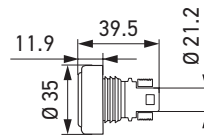

Rubber Housing

PROGRAM OVERVIEW

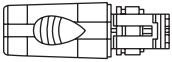
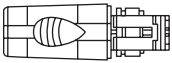
Connection	Housing	Part number	Packing (pieces)
 AMP-SUPERSEAL AMP 282080-1	Rubber Housing	2BM 340 825-211	1
		2BM 340 825-217	7
 AMP-SUPERSEAL AMP 282080-1	Plastic Housing	2BM 340 825-311	1
		2BM 340 825-317	7

* Service Set not included 9XX 340 879-00