



## BRIEF INFORMATION

### Module 90 S series

- Halogen replacement series (1,850 lm) and premium LED work lamp series (4,000 lm)
- Longer life and higher efficiency compared to halogen
- Low weight and high corrosion resistance thanks to high-quality materials and coatings

### PRODUCT FEATURES

With the S series, HELLA is launching new LED work lamps from the Module 90 series that offer a high light output with a practical design. The Module 90 S series from HELLA combines innovative LED technology with excellent value for money. Thanks to their compact dimensions, the flush-mounted work lamps can be used universally and existing halogen headlamps can be quickly and easily converted to powerful LED technology.

In addition, the Module 90 S series work lamps impress with 1,850 lumens – or as premium LED work lamps with a high light output of 4,000 lumens. The excellent lumen/watt performance achieves a high efficiency compared to halogen devices.

The lamps' new, efficient cooling fin design with better heat dissipation ensures a long lifetime. The particularly effective integrated thermal management protects the headlamp with automatic dimming against the threat of overheating between + 50 °C and + 85 °C.

Weight reduction and high corrosion resistance are ensured in the 1,850 lumen versions by the housing and cover lenses made of special plastic. The powerful 4,000 lumen variants are equipped with a high-quality die-cast aluminium housing: corrosion protection is achieved through the surface coatings.

Produced in Austria according to the latest technological standards, the work lamps meet the highest EMC requirements.

# TECHNICAL DETAILS

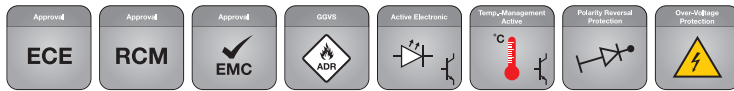

Technical data		
Variant	1,850	4,000
Operating voltage	Multi-voltage (9 - 32 V)	
Rated voltage	12 V / 24 V	
Current consumption	ø 1.6 A (12 V) ø 0.8 A (24 V)	ø 3.4 A (12 V) ø 1.7 A (24 V)
Power consumption	ø 19 W	ø 39.5 W
Light output	1,850 lm	4,000 lm
Light source	LED	
Colour temperature	6,500 K*	
Material	Housing: plastic Cover lens: plastic	Housing: die-cast aluminium Cover lens: plastic
Weight	256 g	575 g
Temperature range	- 40 °C to + 85 °C Maximum light output up to + 50 °C Reduced light output between + 50 °C and + 85 °C**	
Protection class	IP 6K7, IP 6K9K	
Type approval	UKCA, ECE-R10, RCM, ADR / GGVSEB	
EMC protection	CISPR 25	
Mounting	Flush mounting	
Connection	DEUTSCH DT connector	
Manufactured in	Austria	

\* 5,000 K variants available on request.

\*\* From + 50 °C to + 85 °C, the work lamp dims automatically to protect itself.

## Dimensional sketch

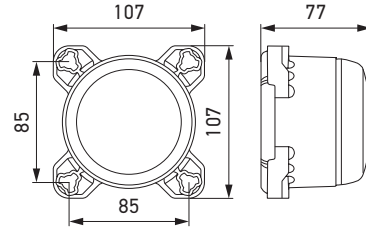

Variant 1,850

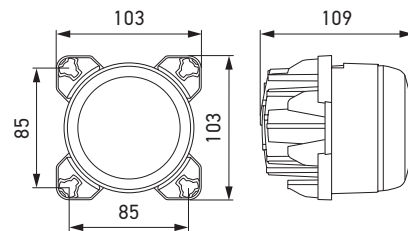



Variant 4,000

# PROGRAM OVERVIEW

Product image	Variant	Illumination	Part number	PU*
	1,850	Close-range illumination	<b>160 996 463-007</b>	40
		Long-range illumination	<b>160 996 463-017</b>	40
	4,000	Close-range illumination	<b>160 996 463-407</b>	40
		Long-range illumination	<b>160 996 463-417</b>	40

\* Packaging unit

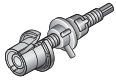
# ACCESSORIES

Product image	Description	Part number
	Adjusting screw group: 3 x ball screw 3 x thread fitting 3 x joint piece	<b>9NS 254 242-091</b>
	2,000 mm cable with DEUTSCH DT connector	<b>8KB 990 299-011</b>

# LIGHT DISTRIBUTION

Variant 1,850

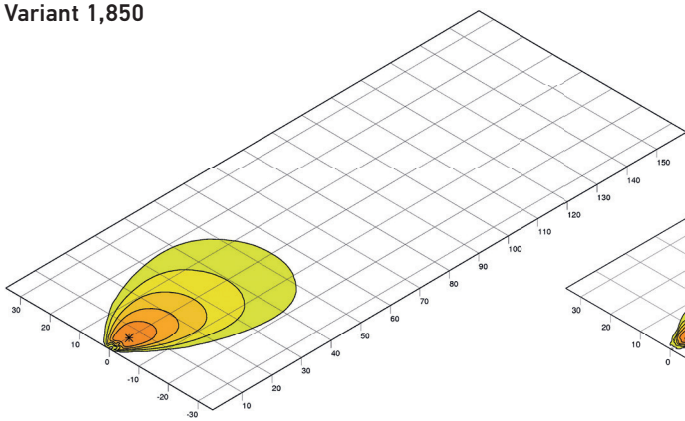

Close-range illumination

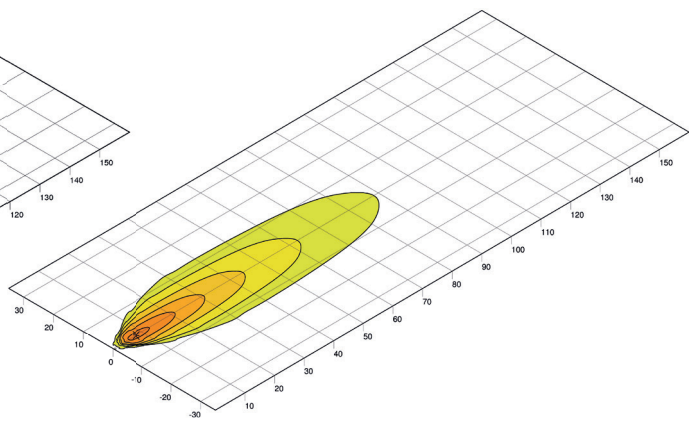

Long-range illumination

Variant 4,000

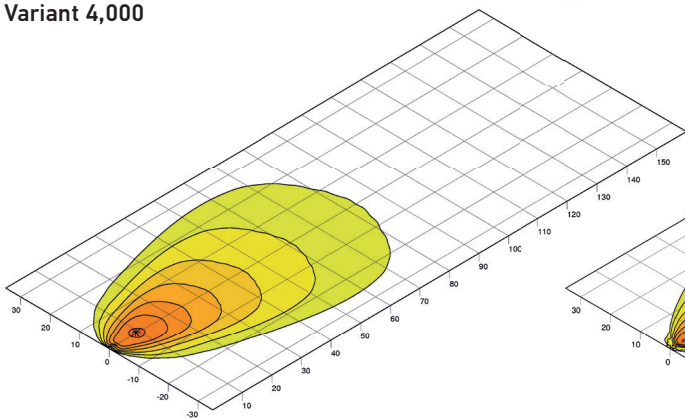

Close-range illumination

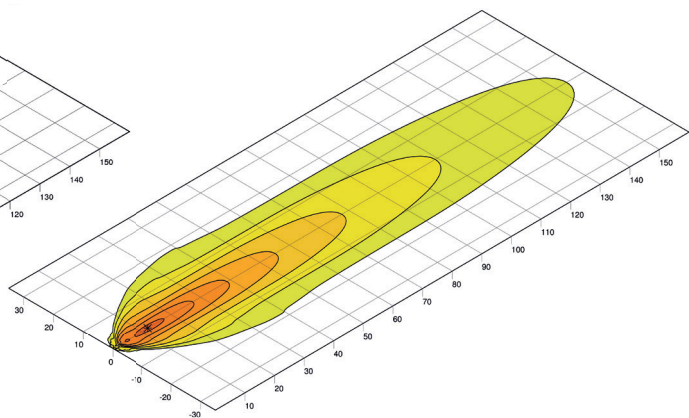

Long-range illumination

